

## Truck crane model

To make this model all you need is just a saw and one big plywood board. On the plywood you should carefully overwrite contours of the truck parts and with the hand or electric saw cut the parts out. It is recommendable to sand all the parts edges with the sandpaper or a rasp, so it will be easy to glue them together. You should use the glue for the wood that can be bought in almost every modeler store.

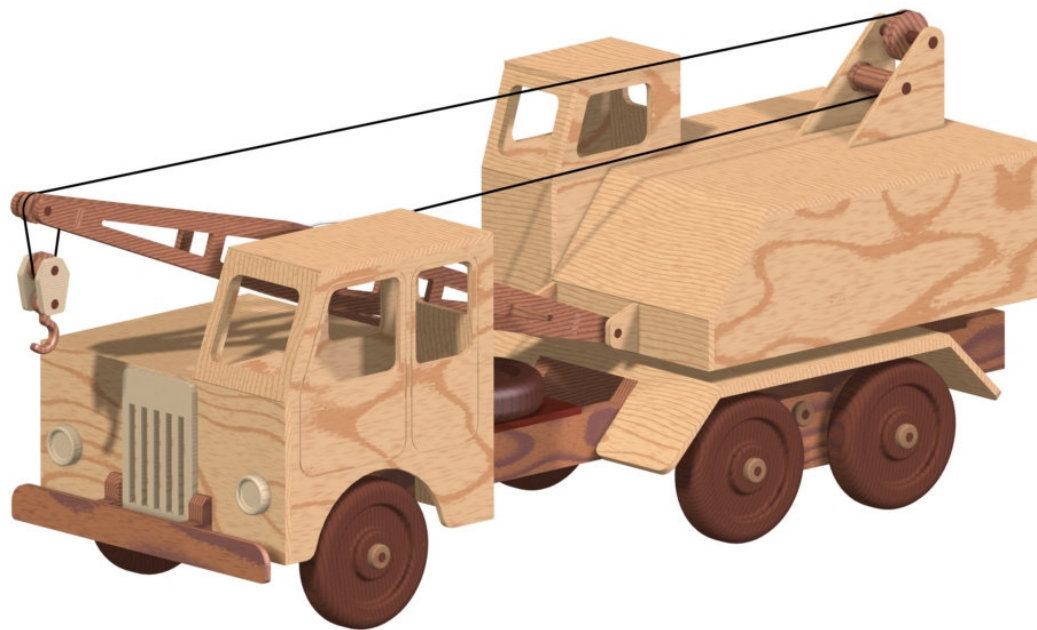

This truck model is just a basic construction which can be decorated in various ways, by adding some minor pieces out of other materials, and painting.

## Truck crane model parts list

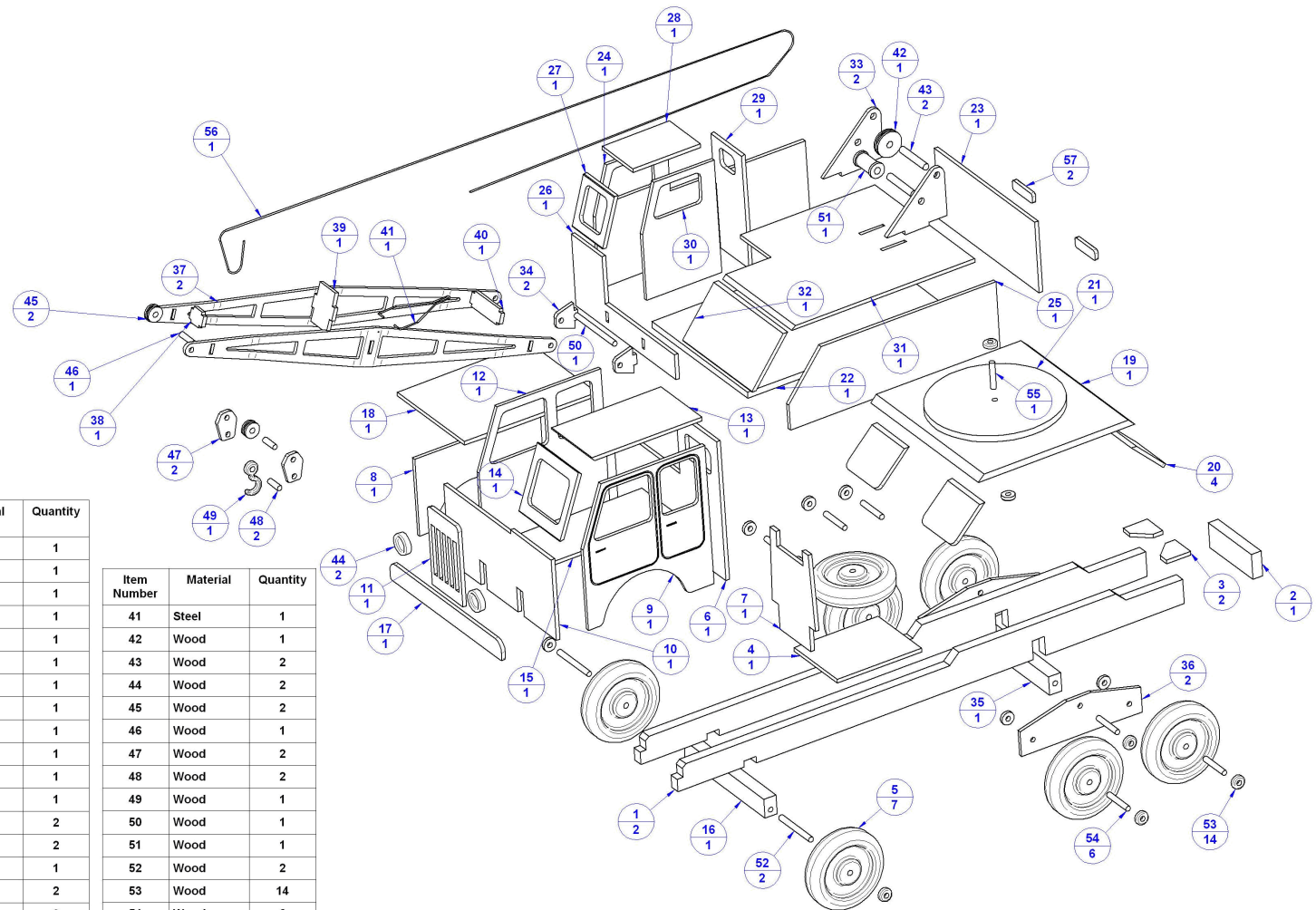

Item Number	Material	Quantity
1	Wood	2
2	Wood	1
3	Wood	2
4	Wood	1
5	Wood	7
6	Wood	1
7	Wood	1
8	Wood	1
9	Wood	1
10	Wood	1
11	Wood	1
12	Wood	1
13	Wood	1
14	Wood	1
15	Wood	1
16	Wood	1
17	Wood	1
18	Wood	1
19	Wood	1
20	Wood	4

Item Number	Material	Quantity
21	Wood	1
22	Wood	1
23	Wood	1
24	Wood	1
25	Wood	1
26	Wood	1
27	Wood	1
28	Wood	1
29	Wood	1
30	Wood	1
31	Wood	1
32	Wood	1
33	Wood	2
34	Wood	2
35	Wood	1
36	Wood	2
37	Wood	2
38	Wood	1
39	Wood	1
40	Wood	1

Item Number	Material	Quantity
41	Steel	1
42	Wood	1
43	Wood	2
44	Wood	2
45	Wood	2
46	Wood	1
47	Wood	2
48	Wood	2
49	Wood	1
50	Wood	1
51	Wood	1
52	Wood	2
53	Wood	14
54	Wood	6
55	Wood	1
56	Cord	1
57	Wood	2

## Truck crane assembly drawing

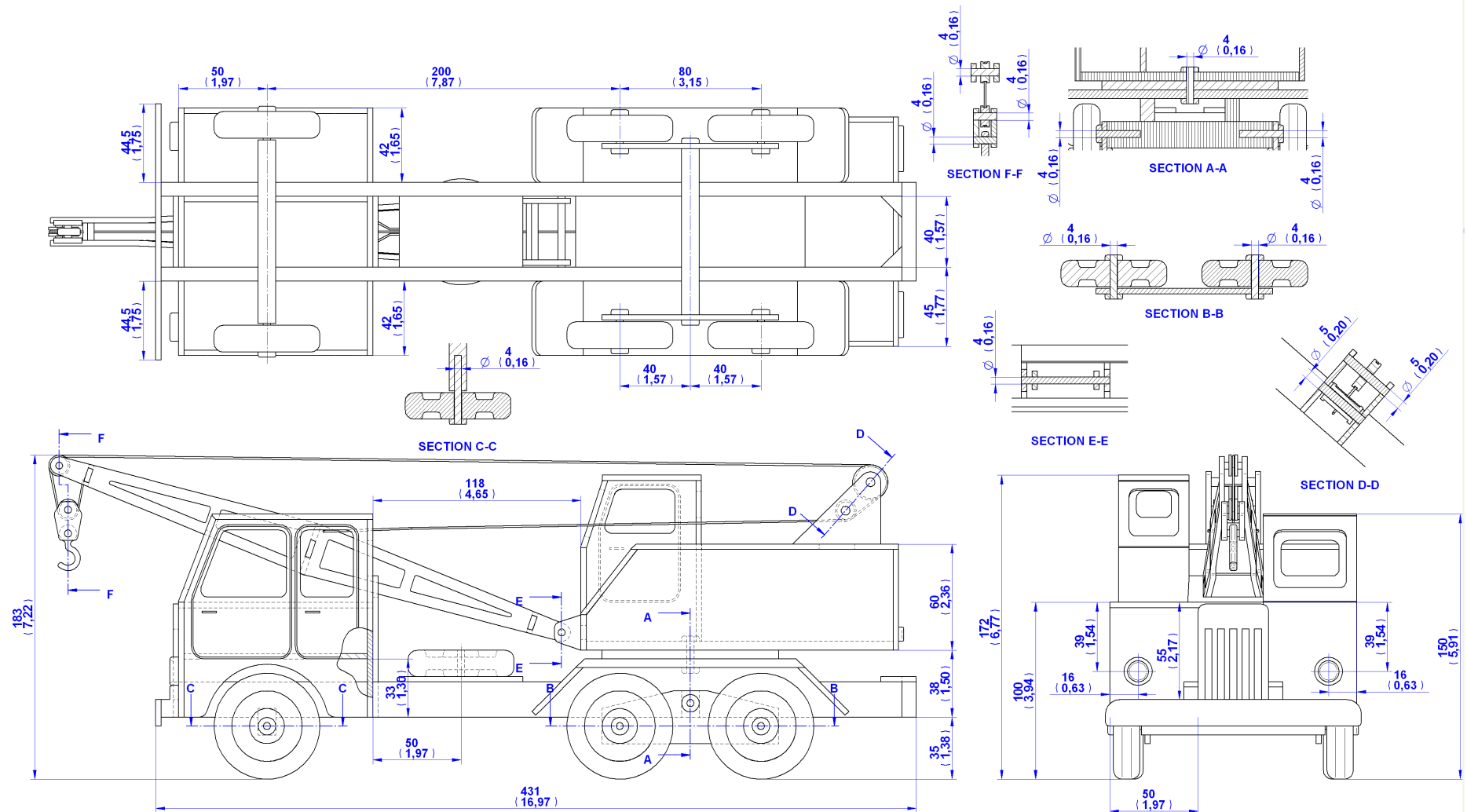



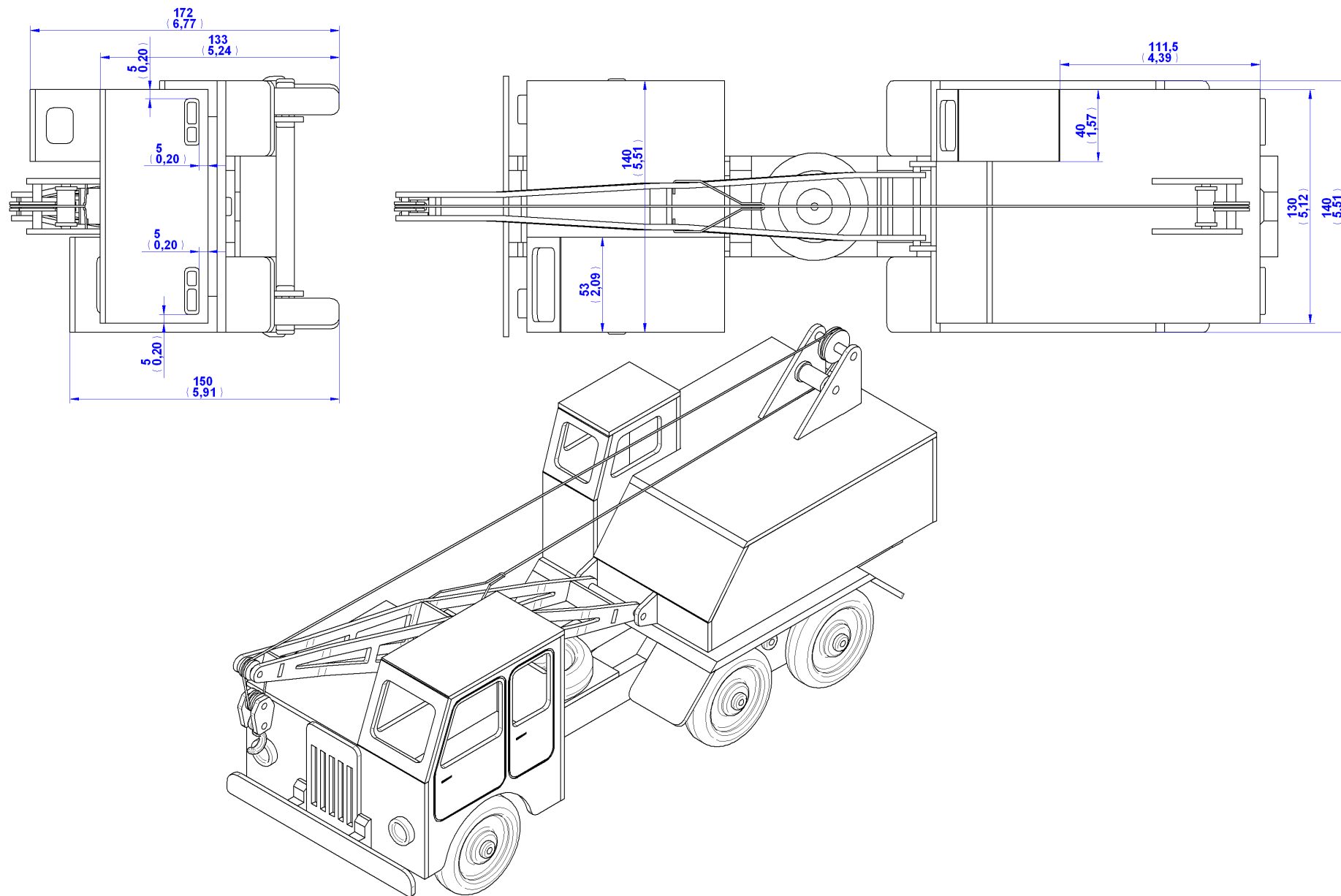



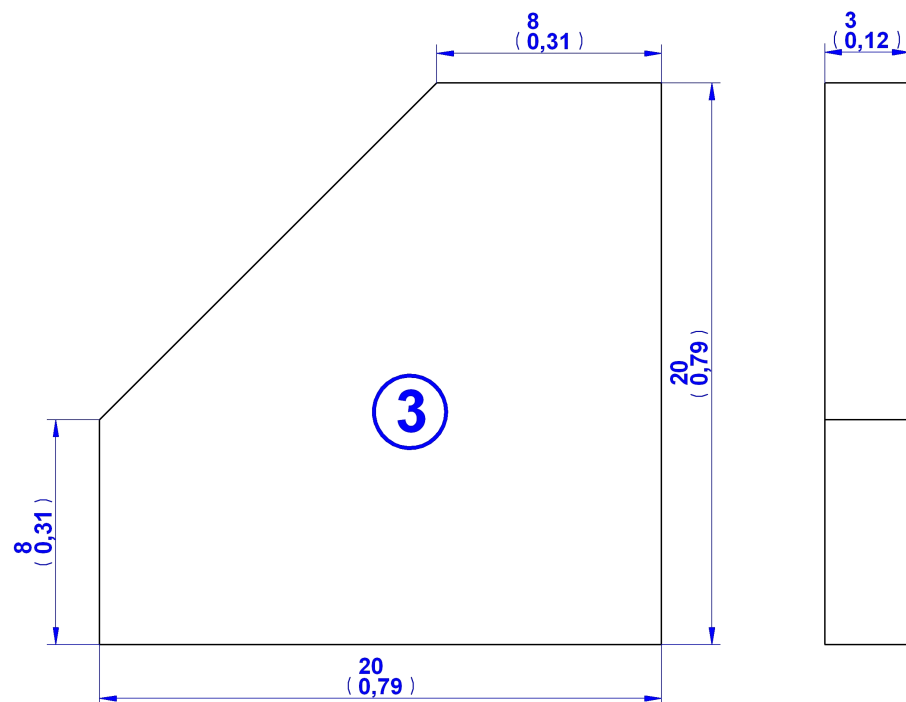
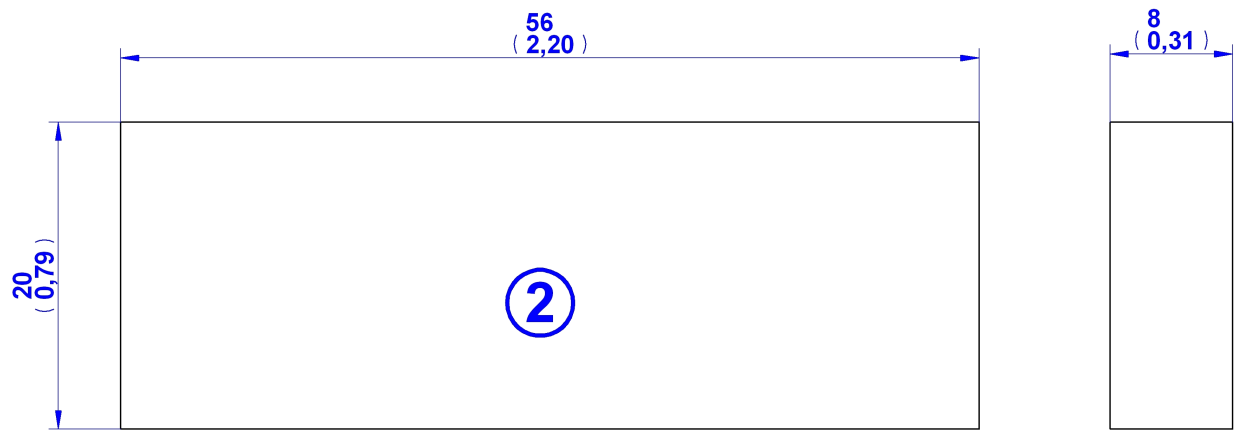

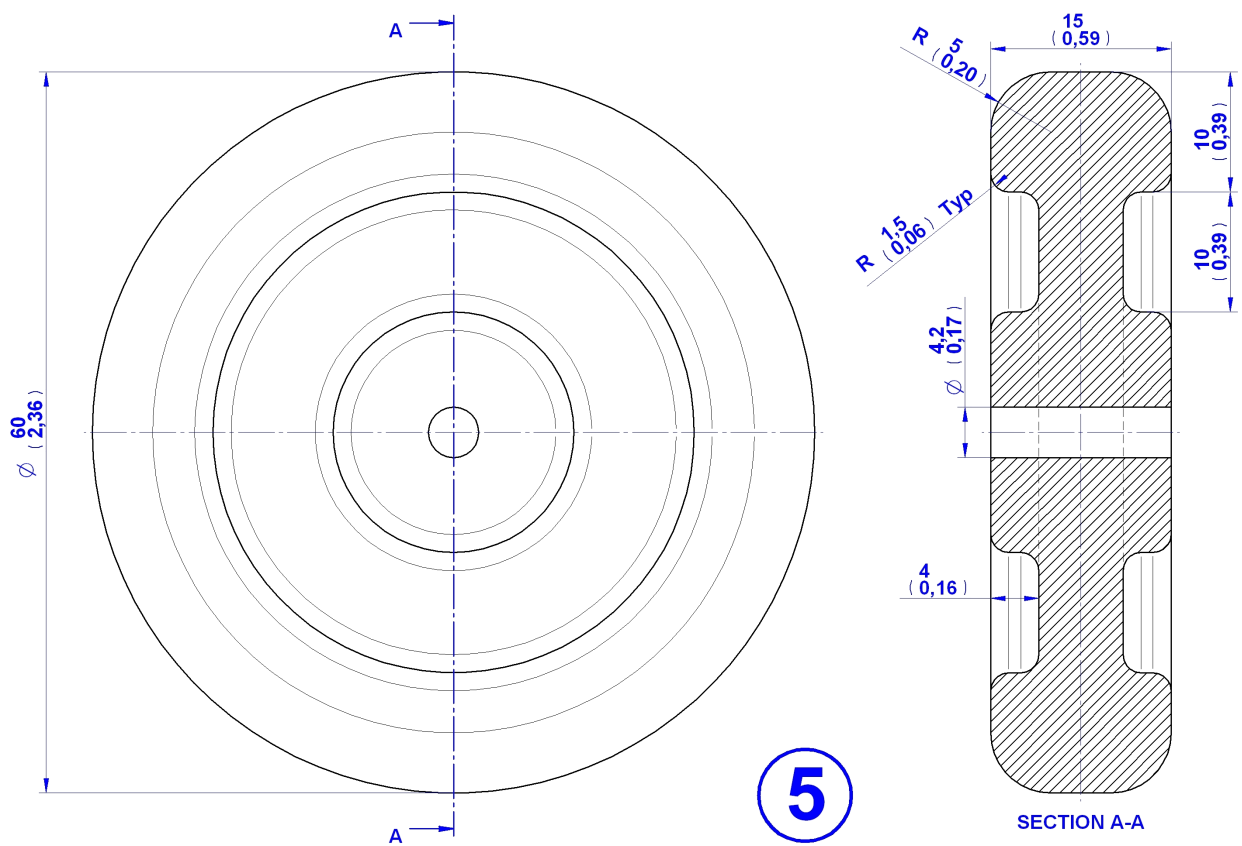
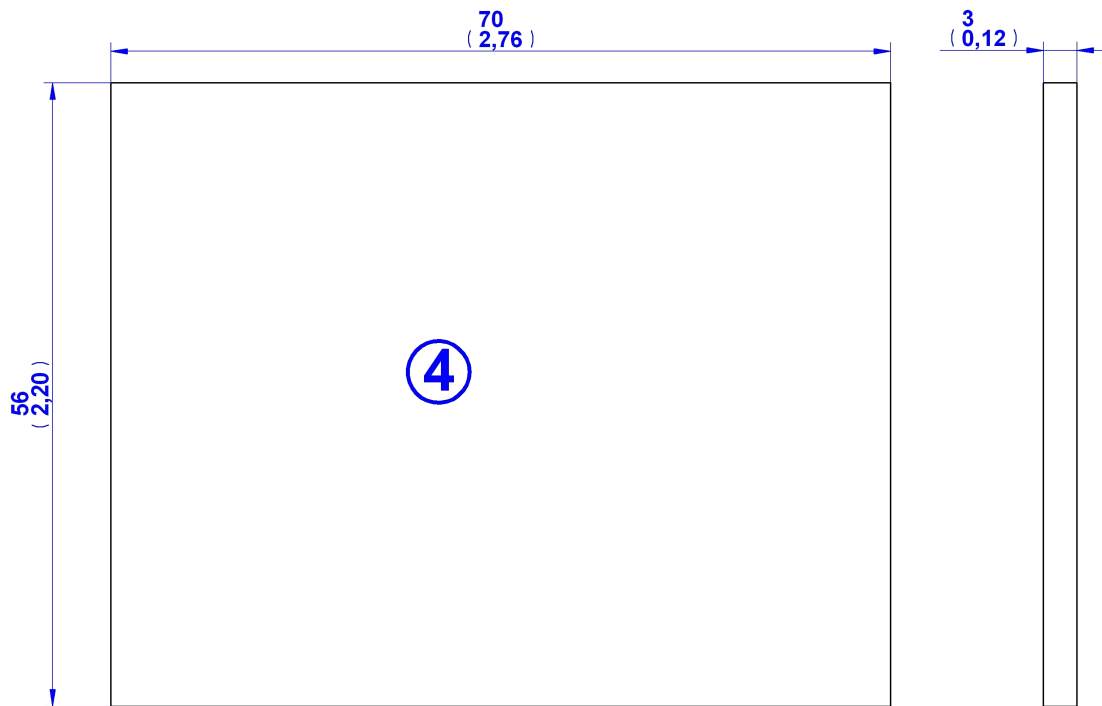



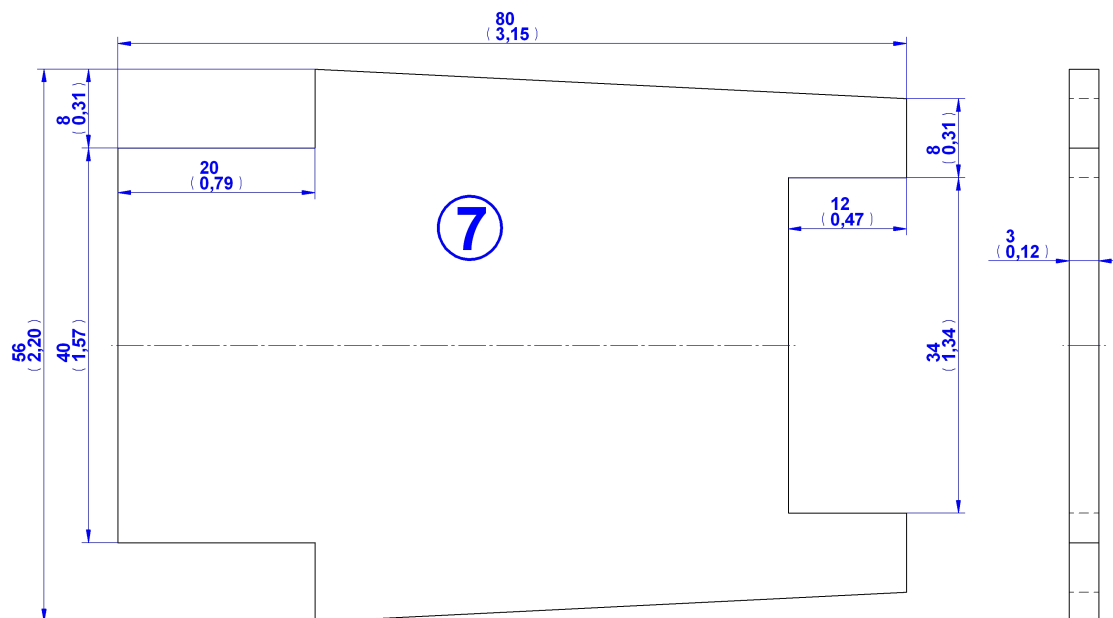
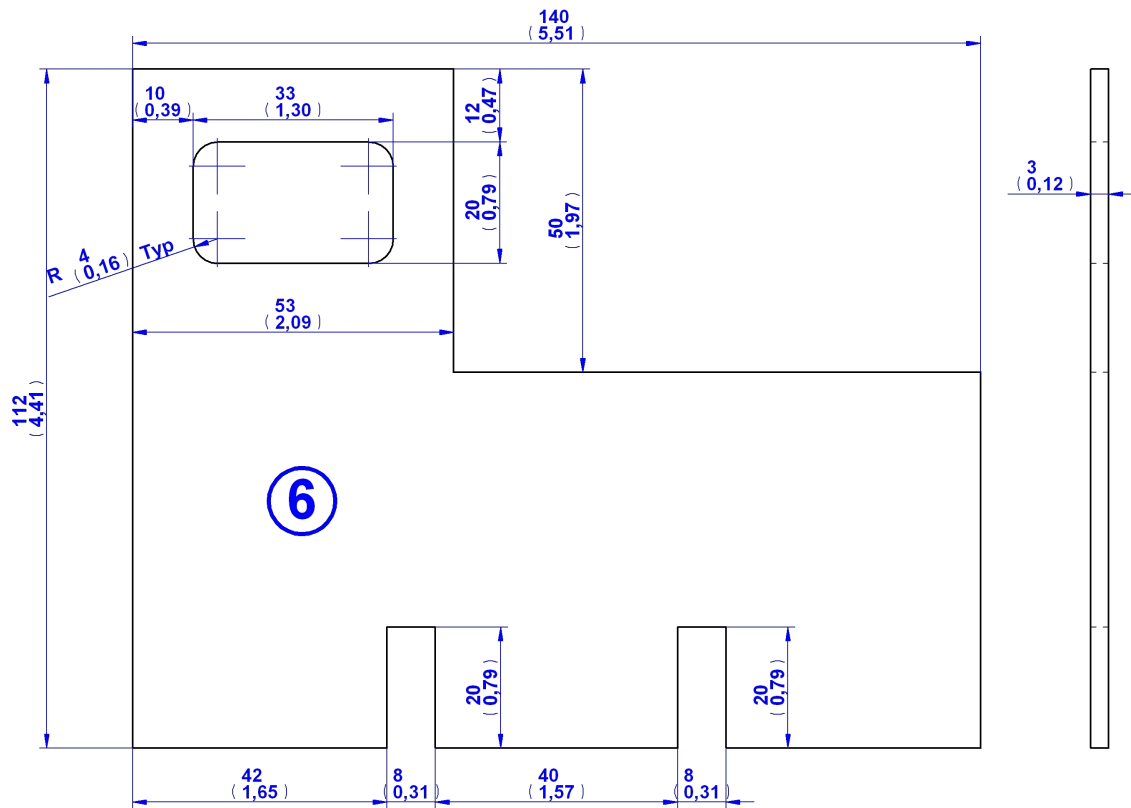

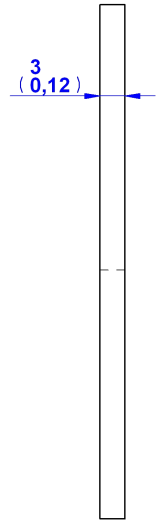

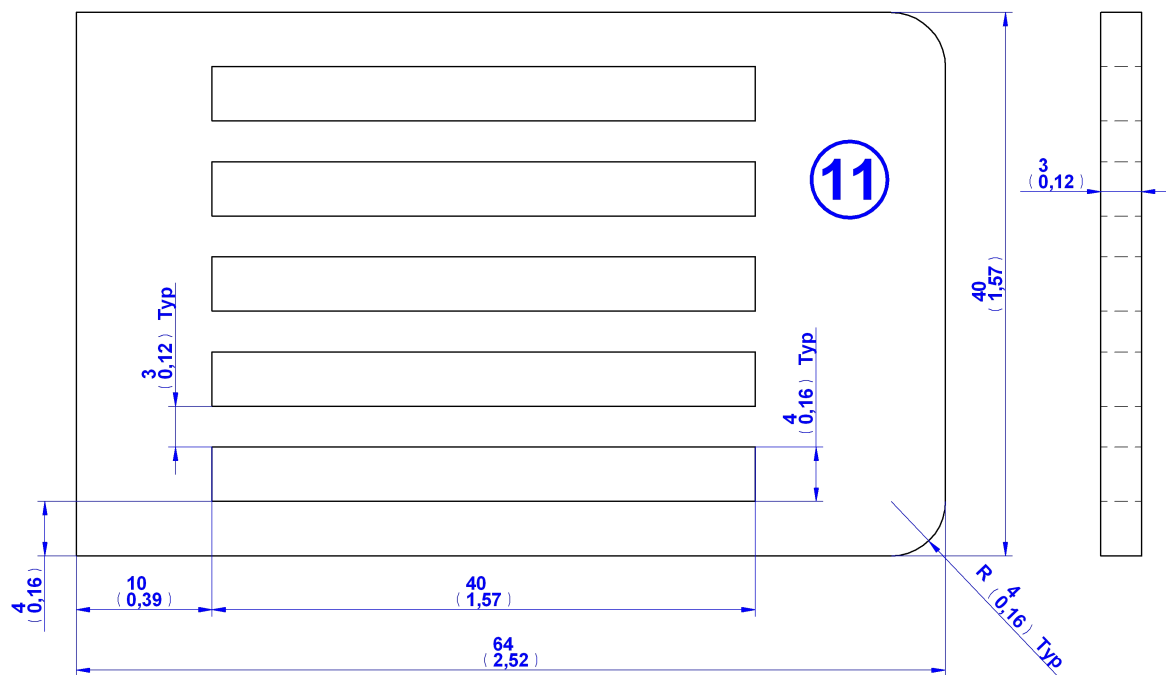
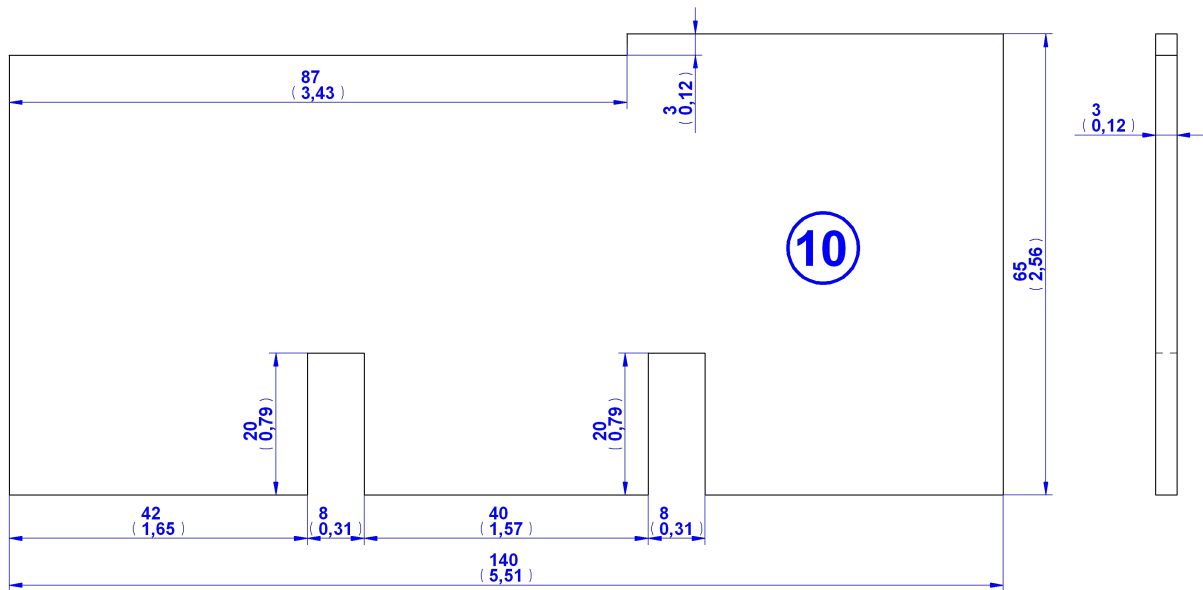

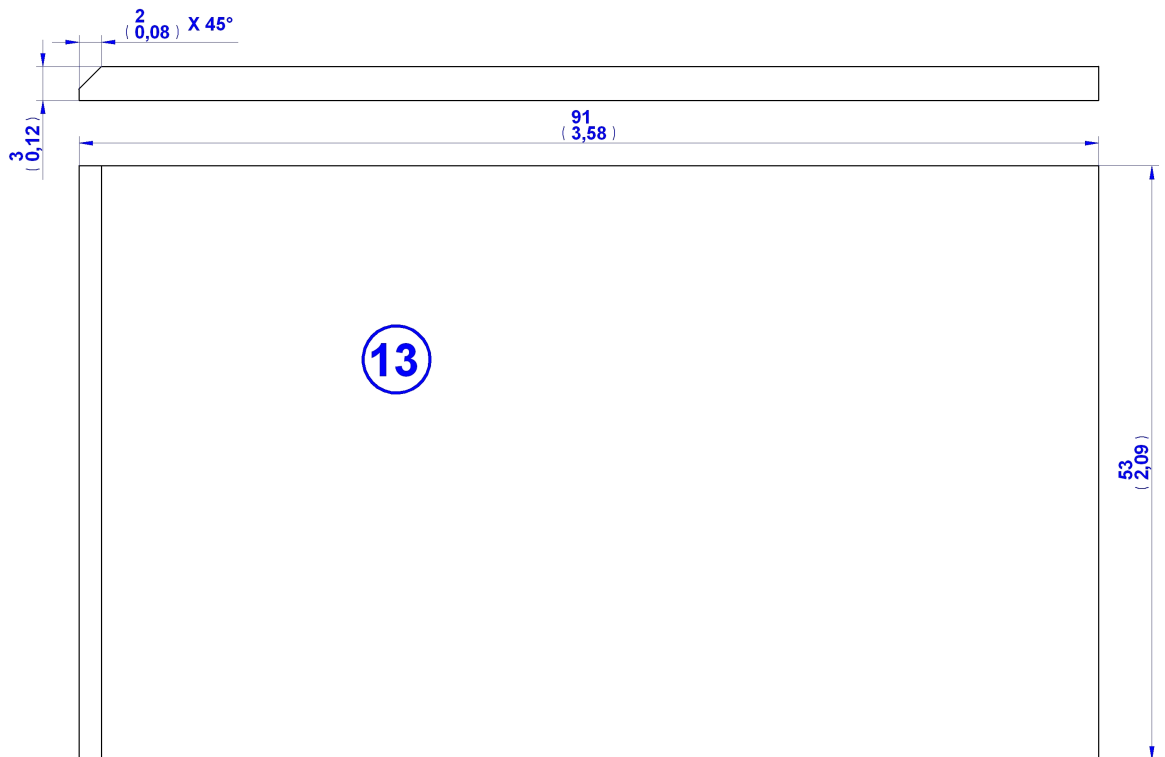

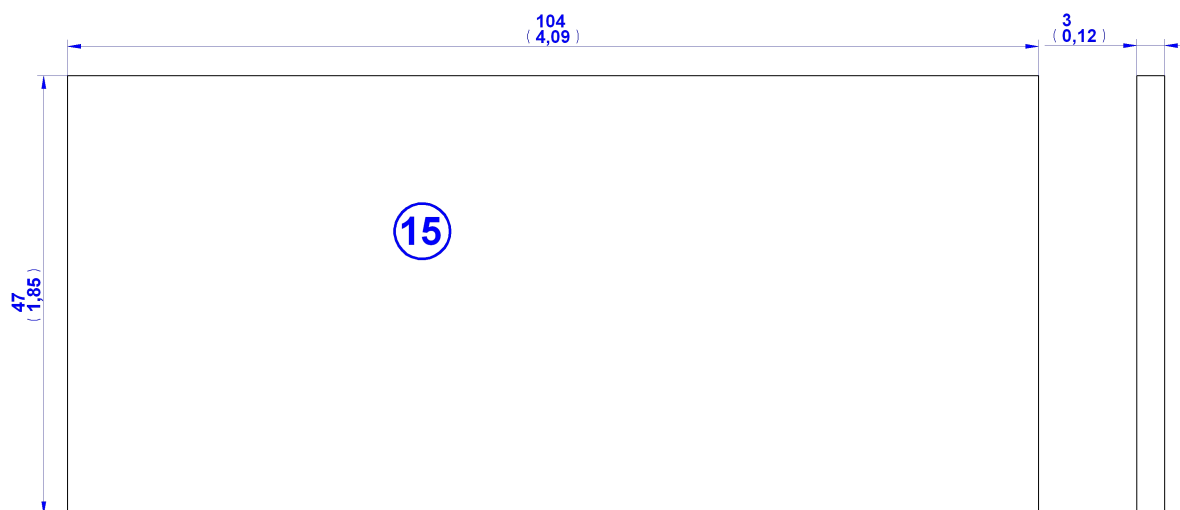
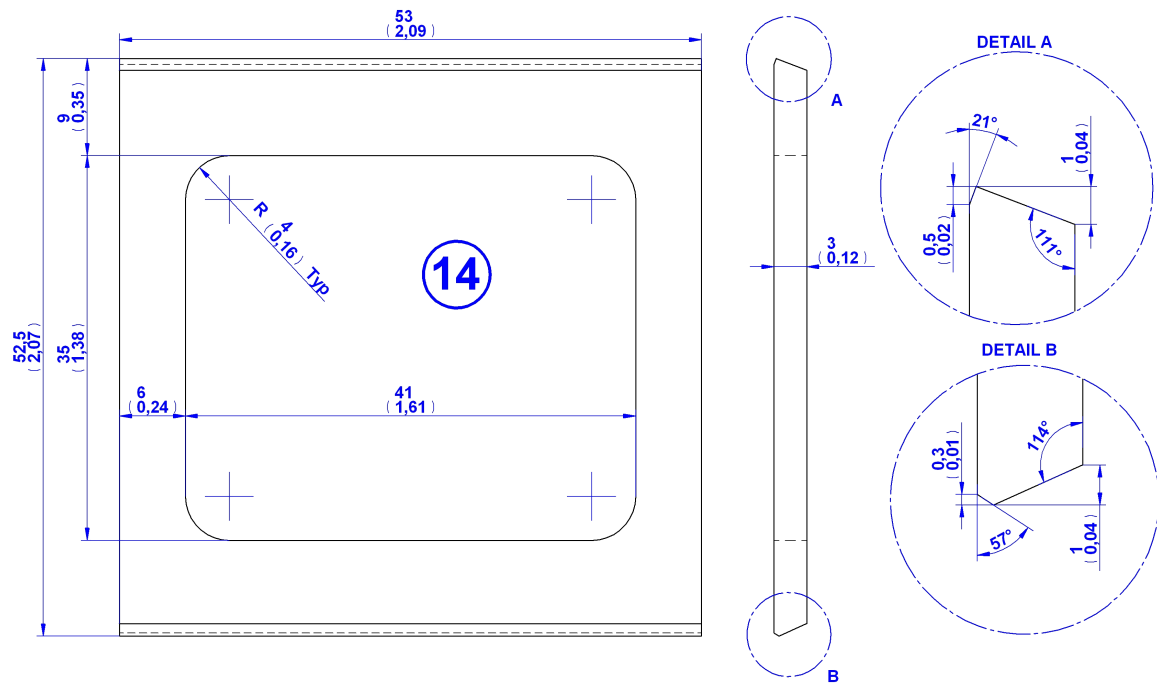

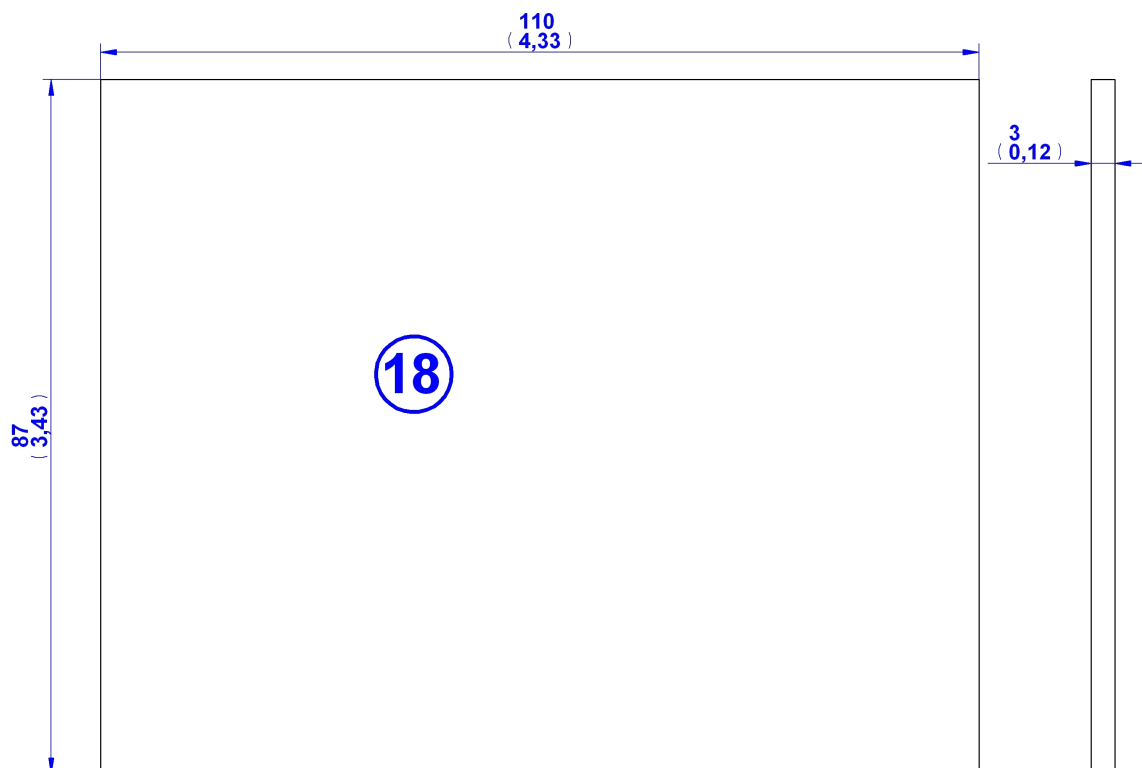
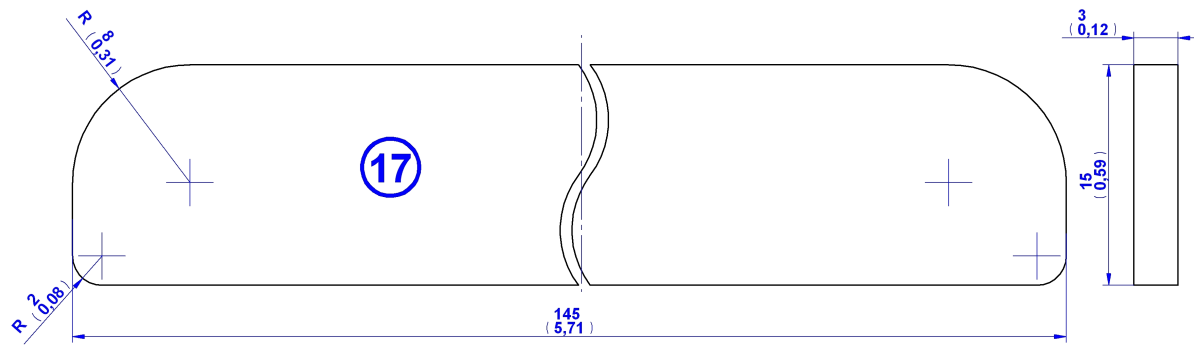
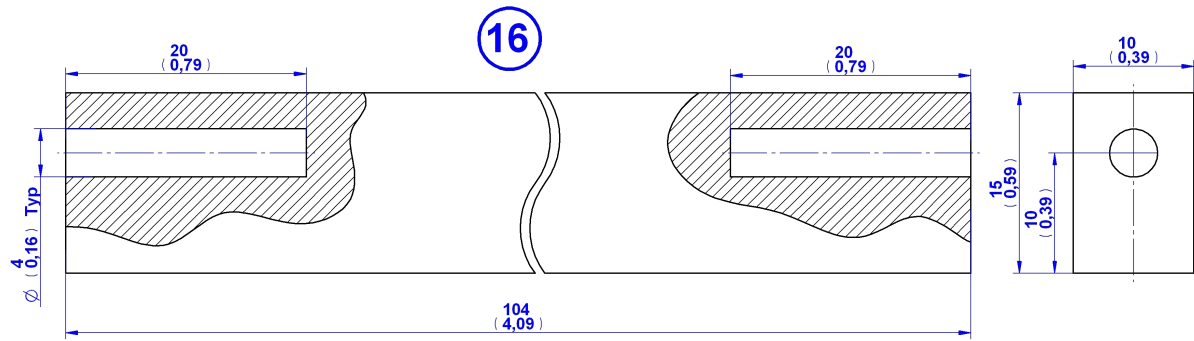

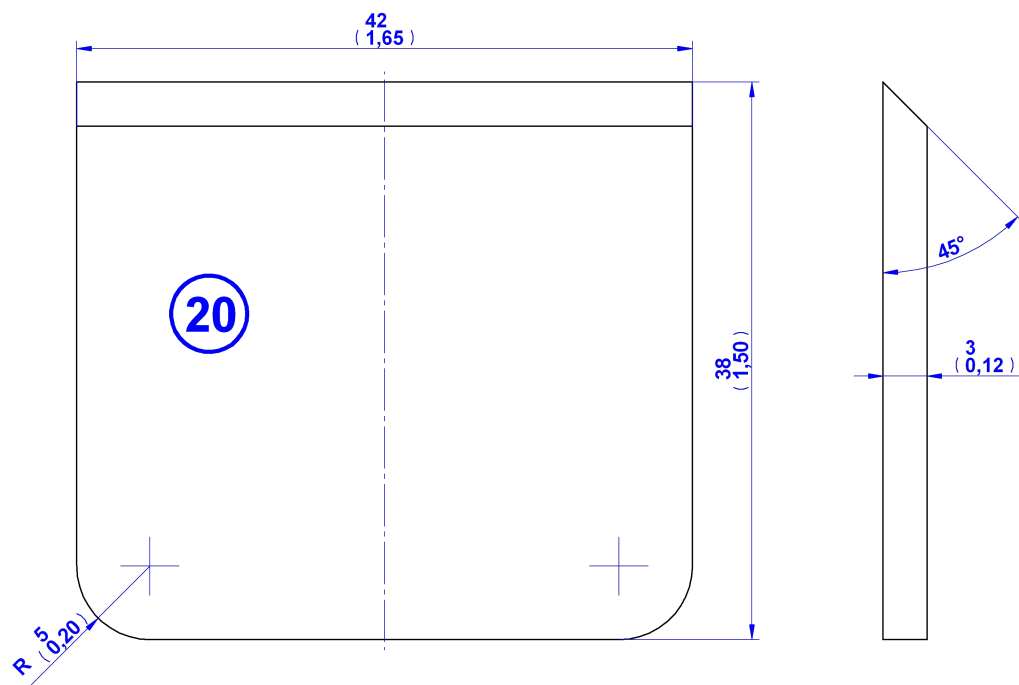
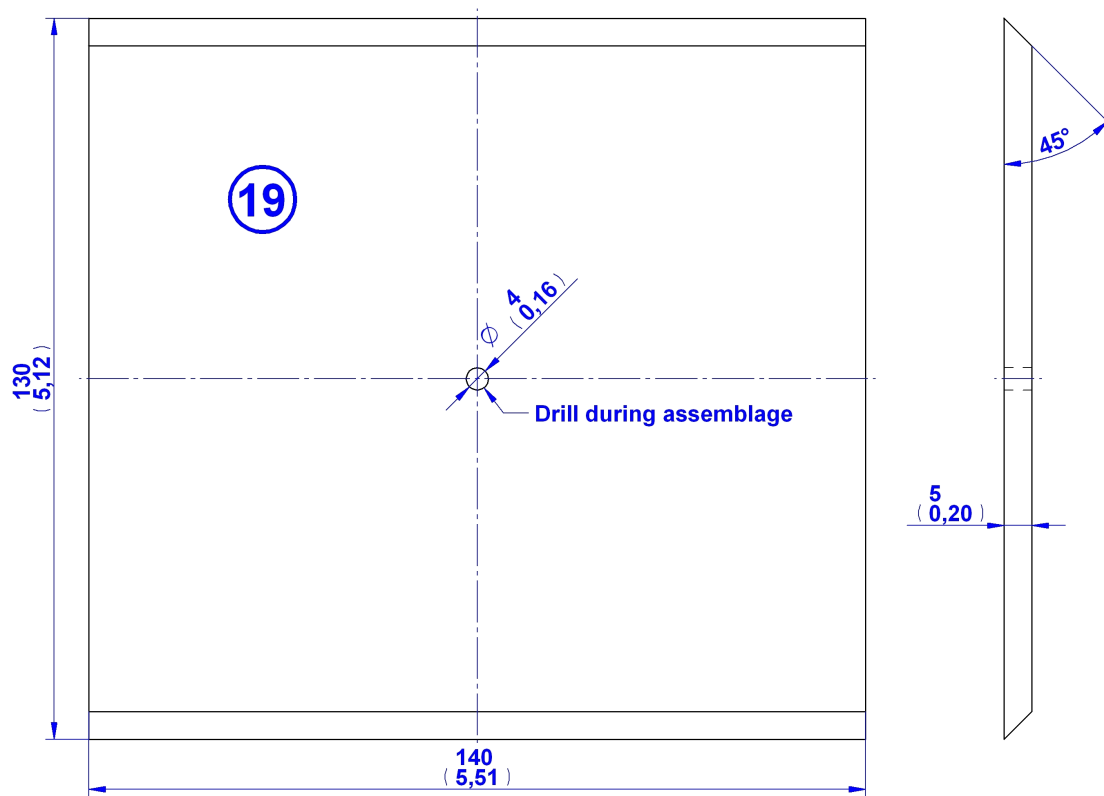

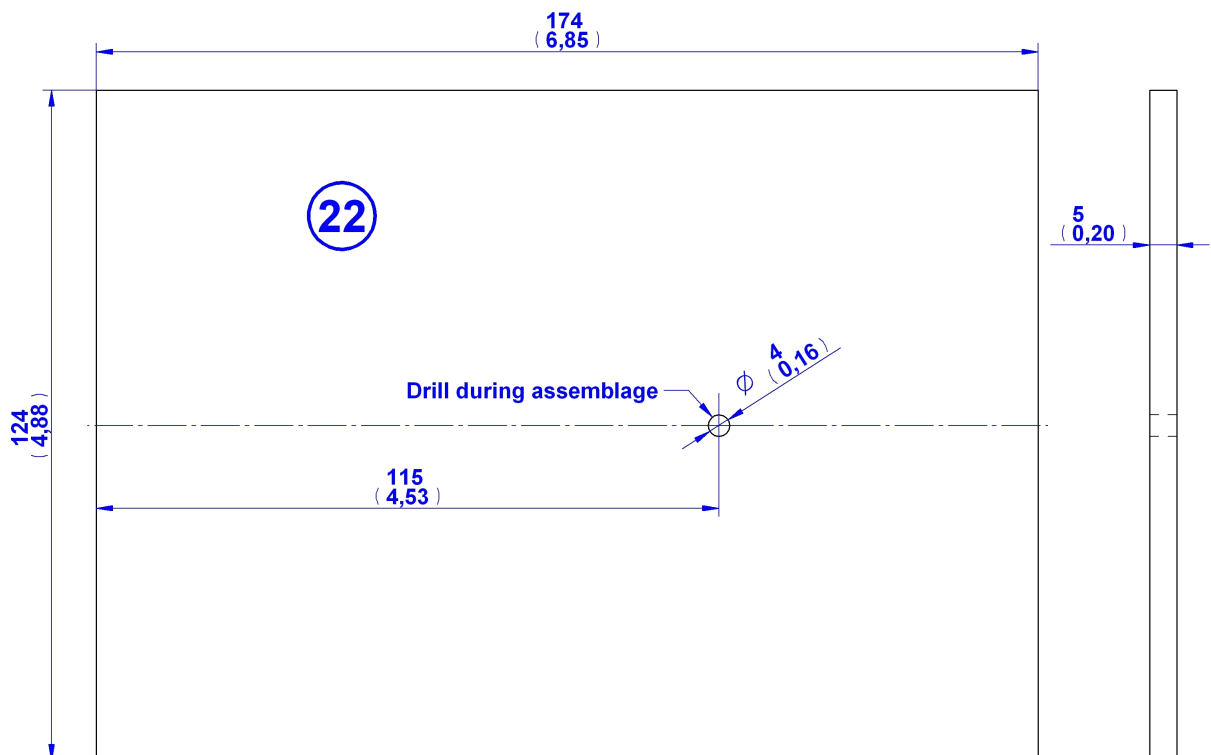
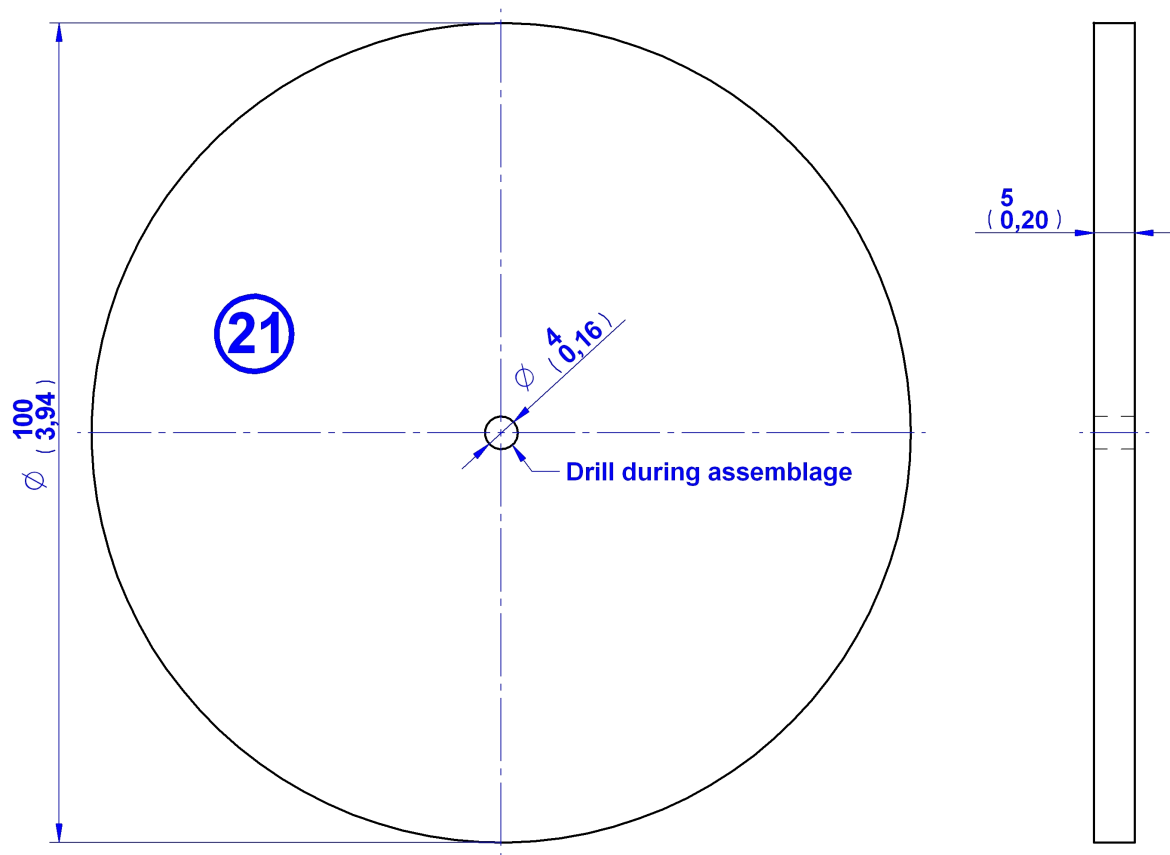



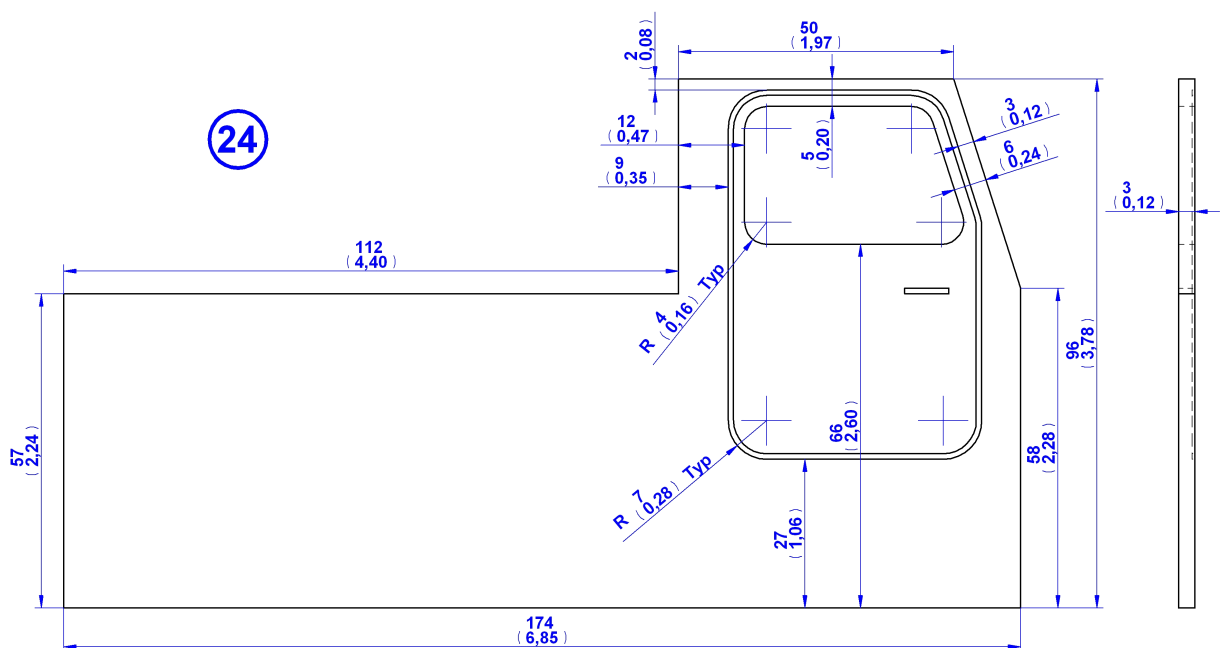
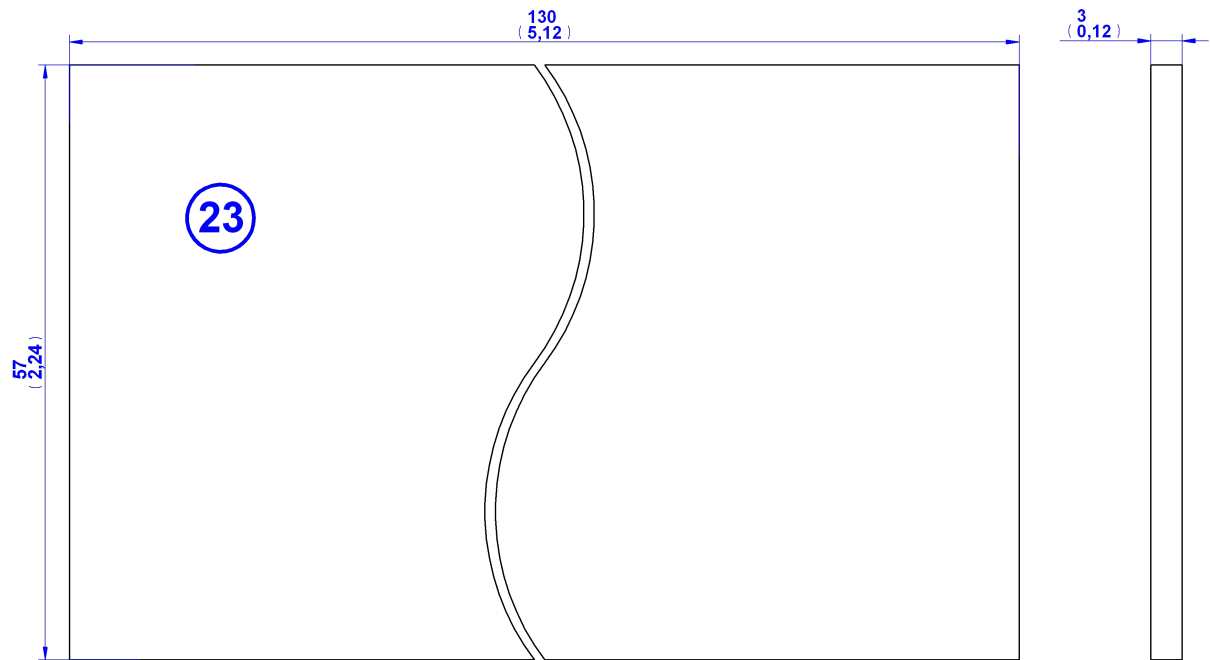

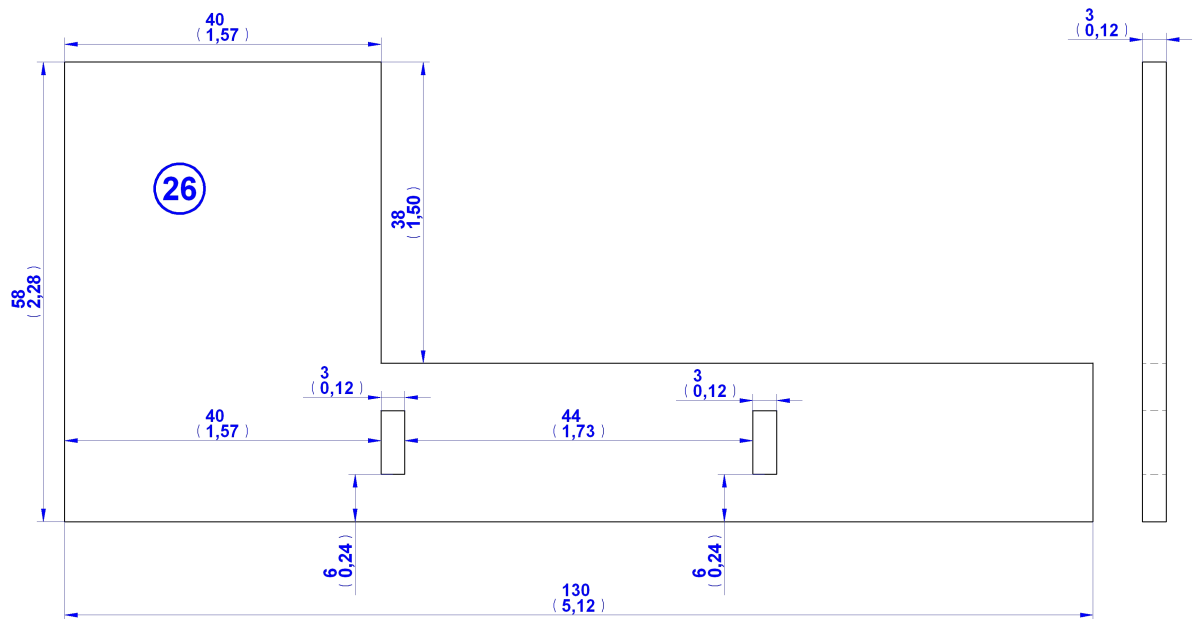
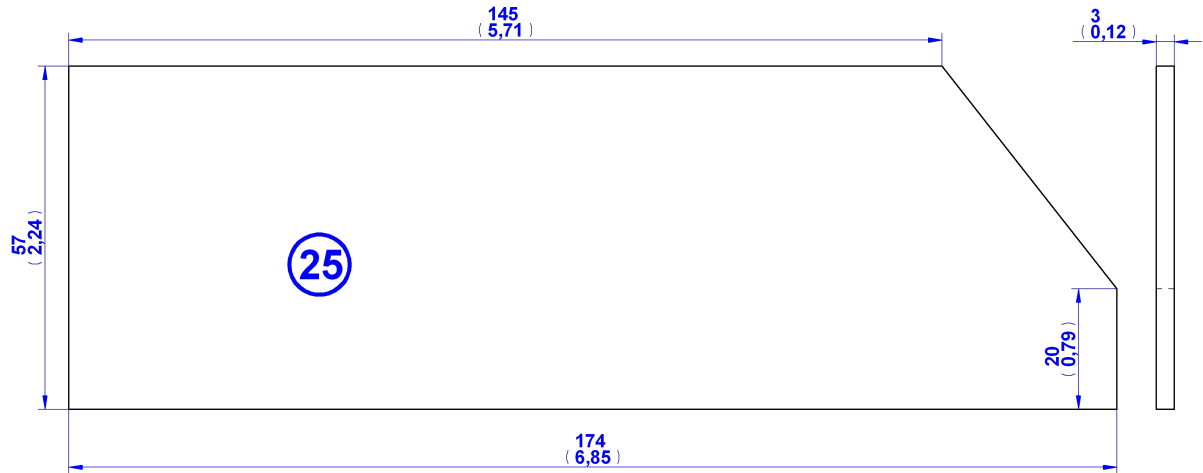

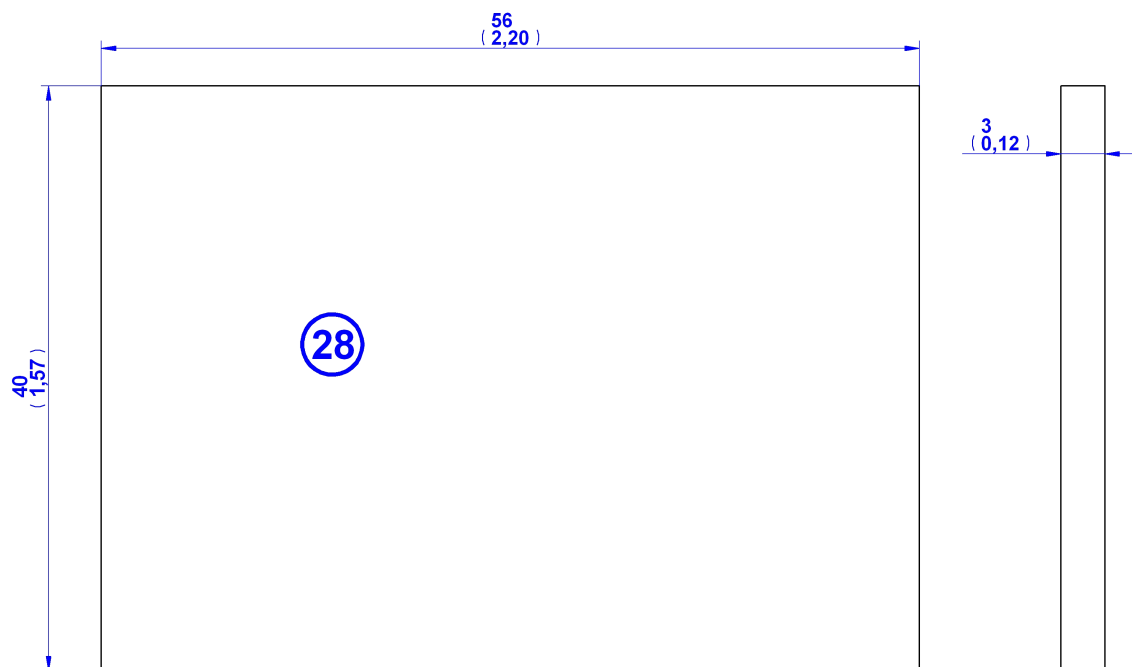
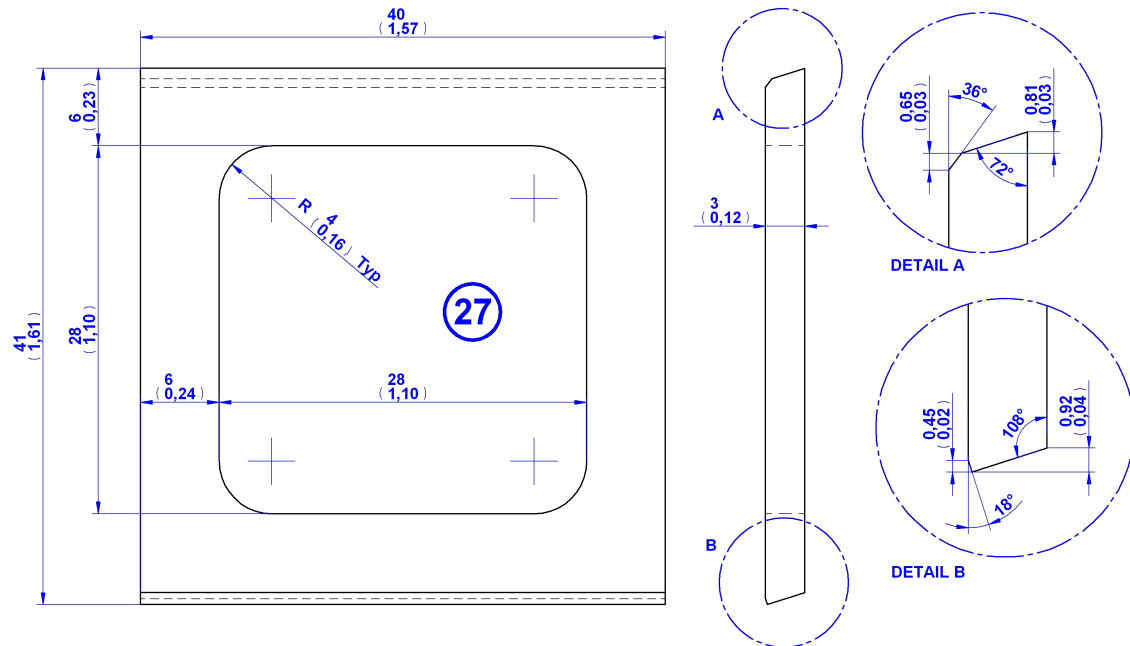

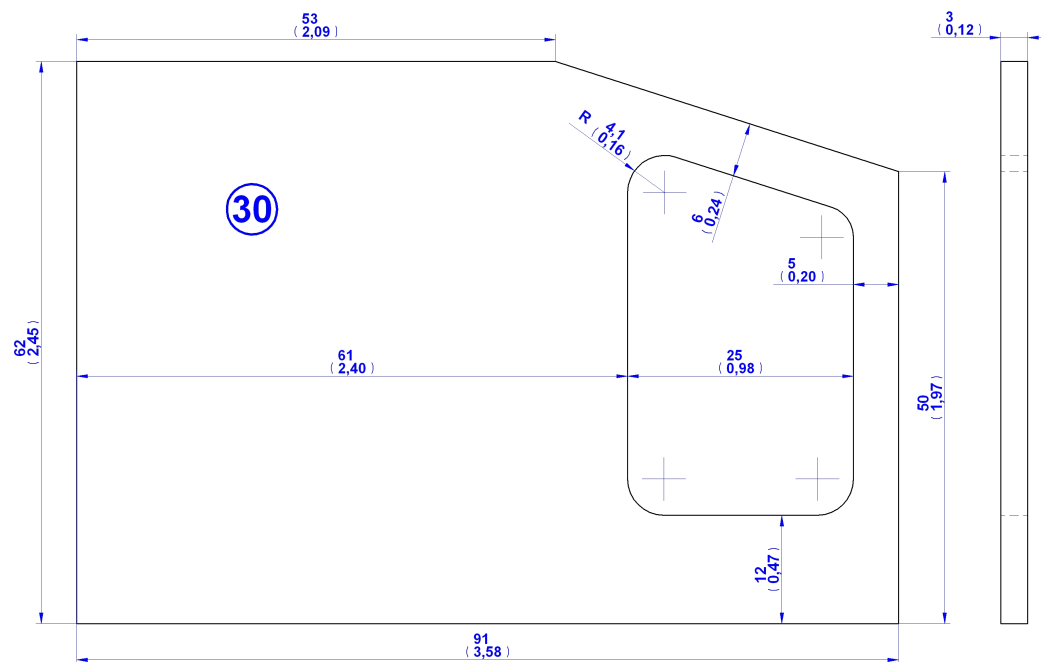
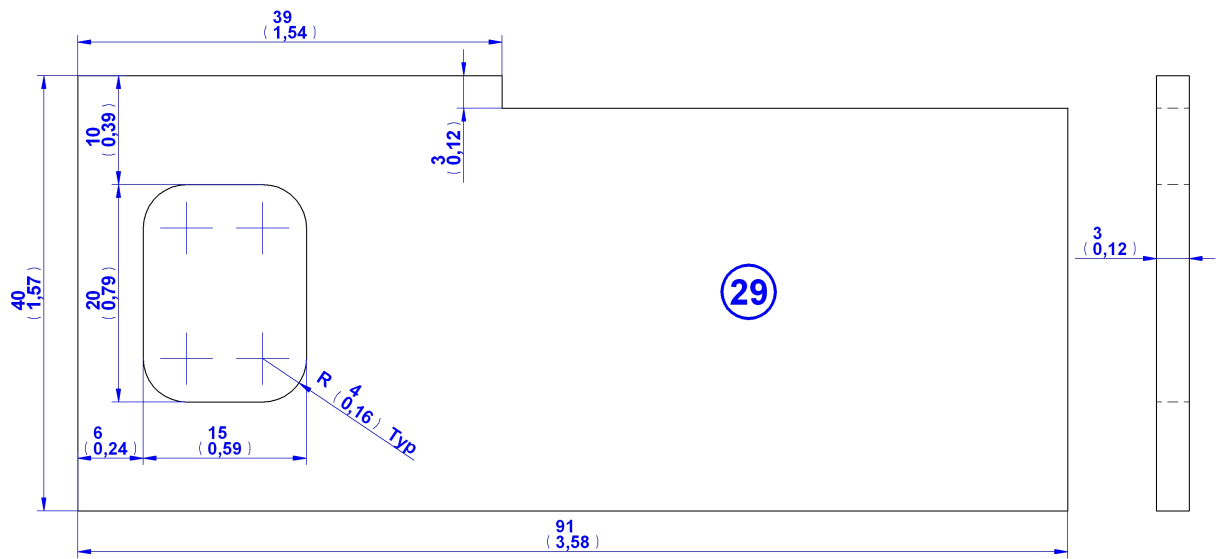

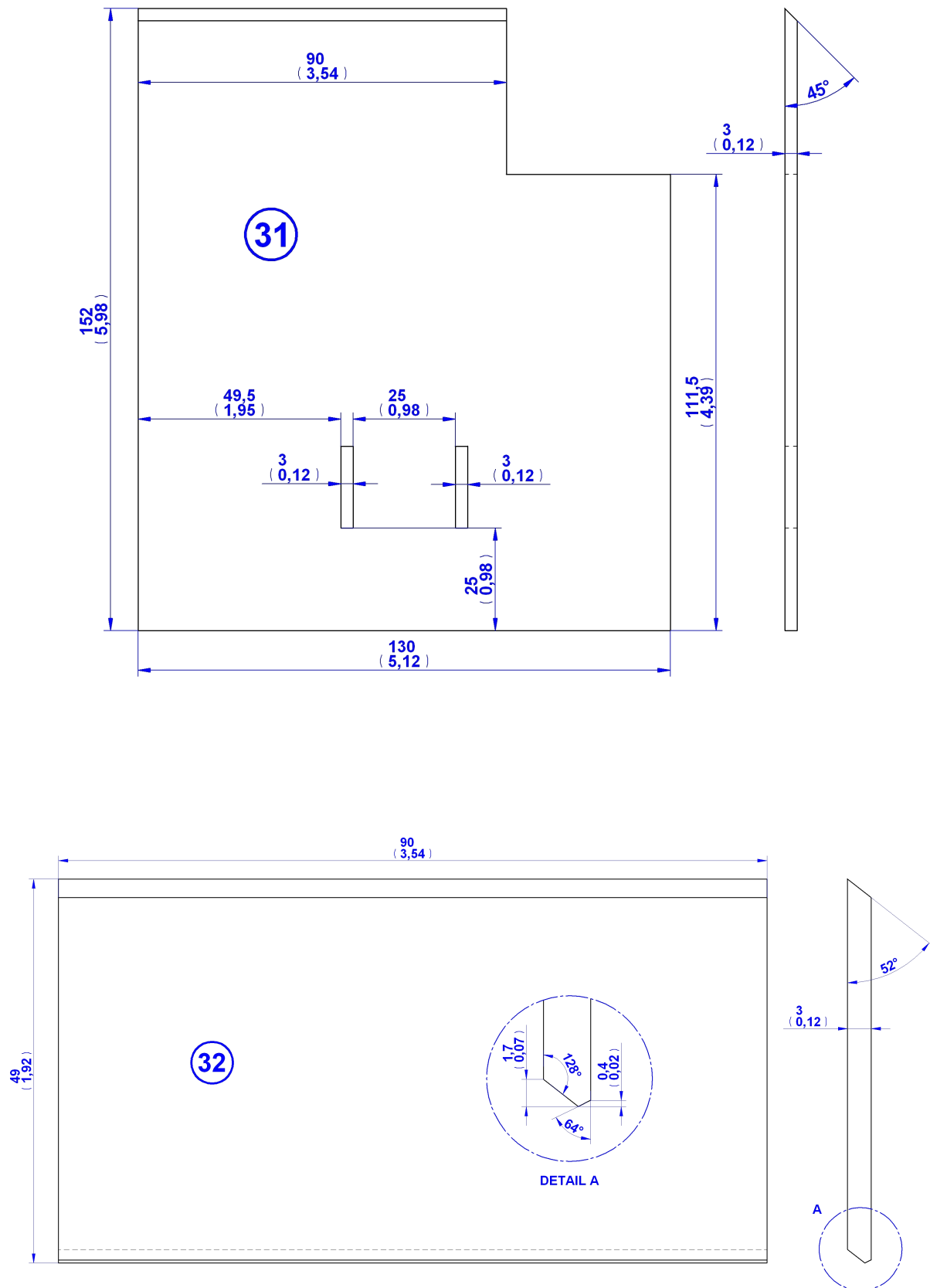

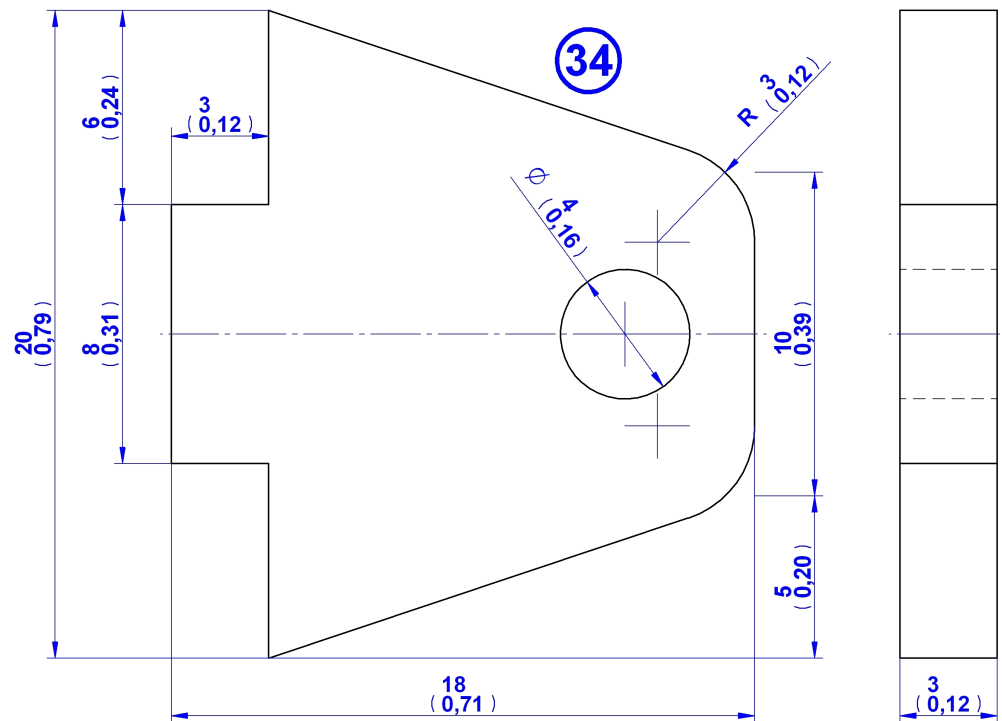
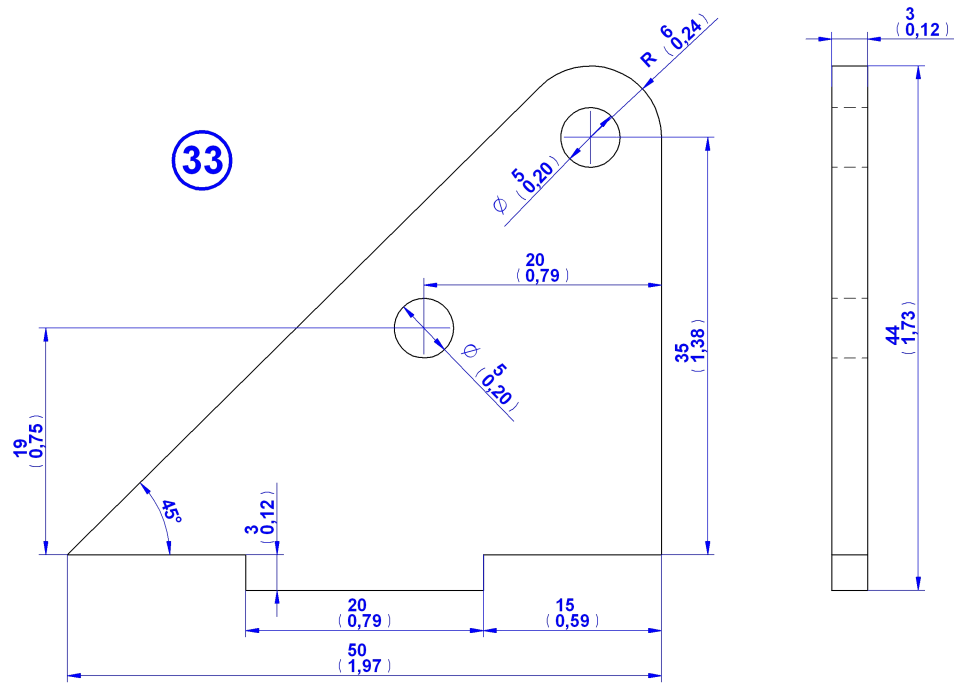

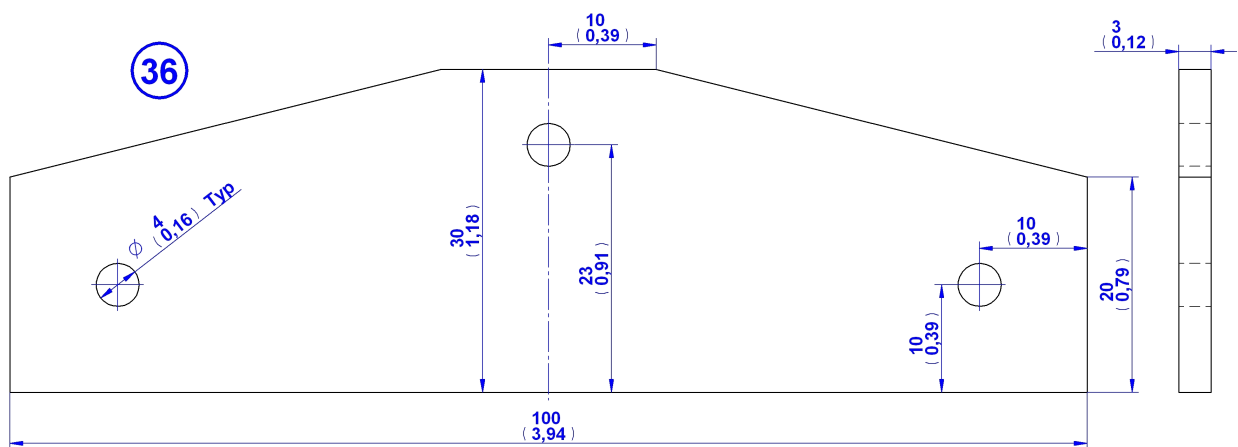
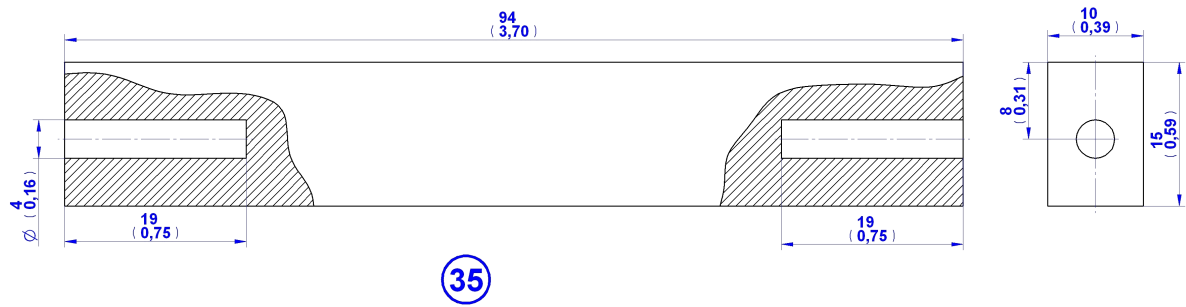

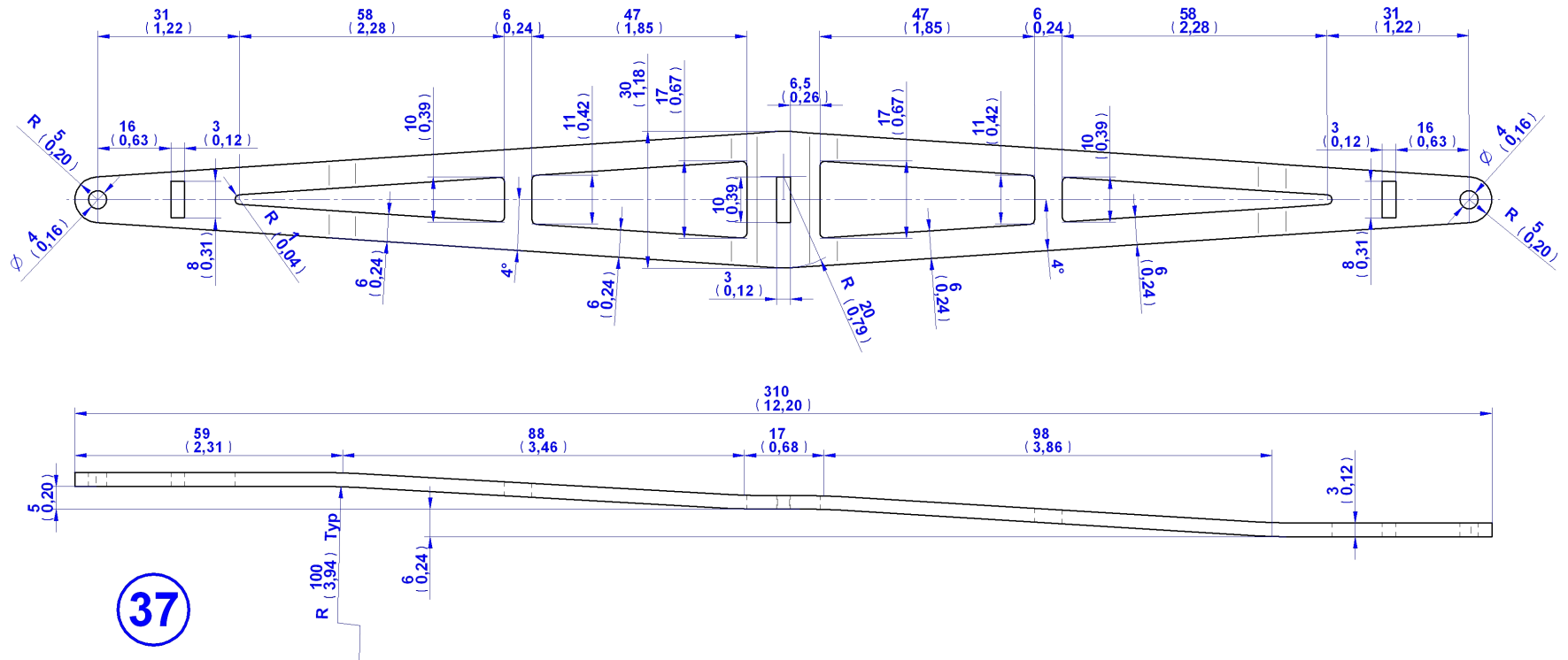



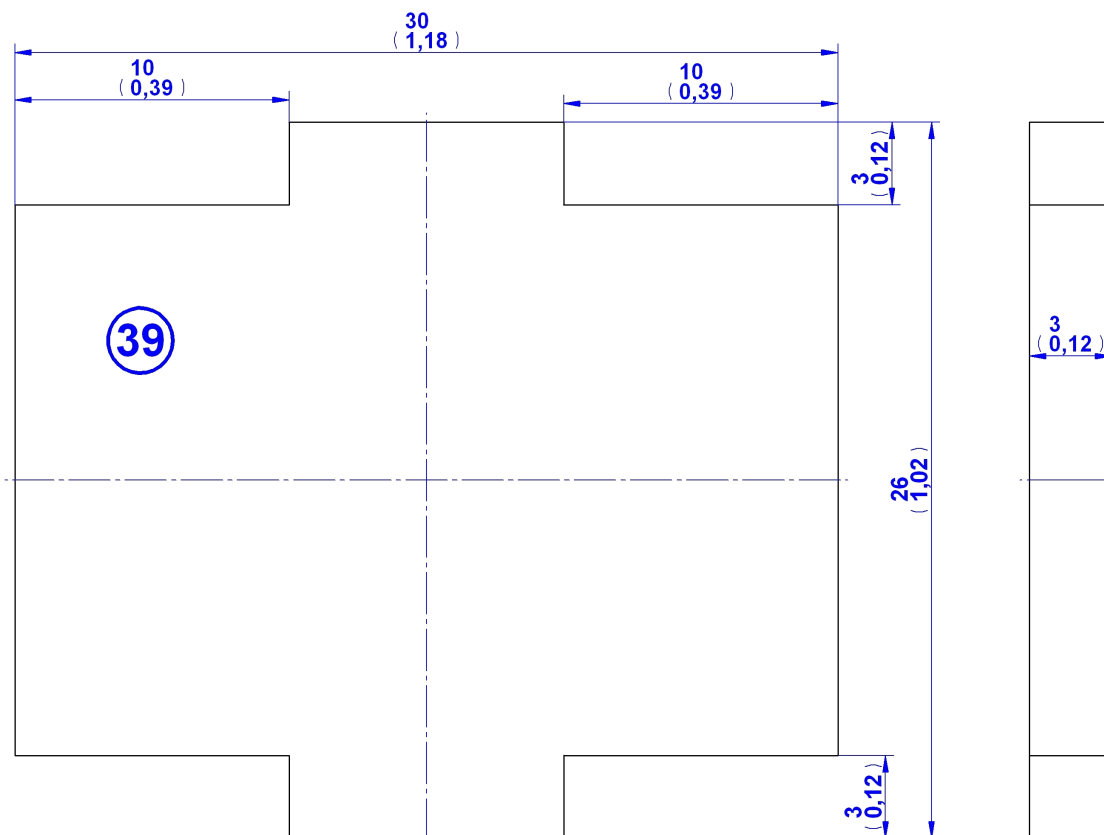
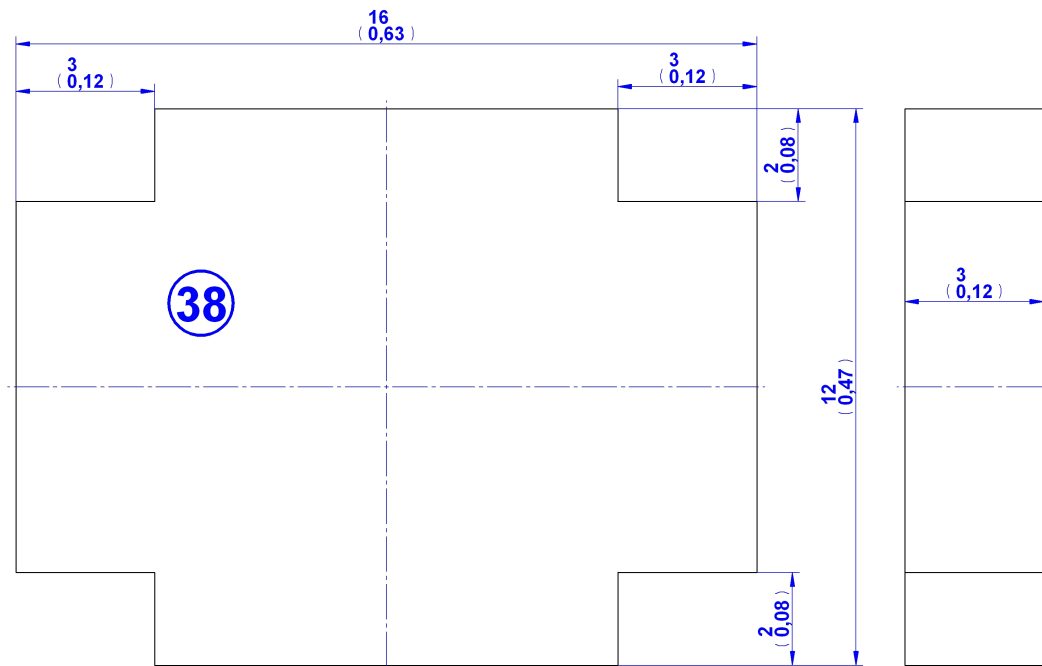

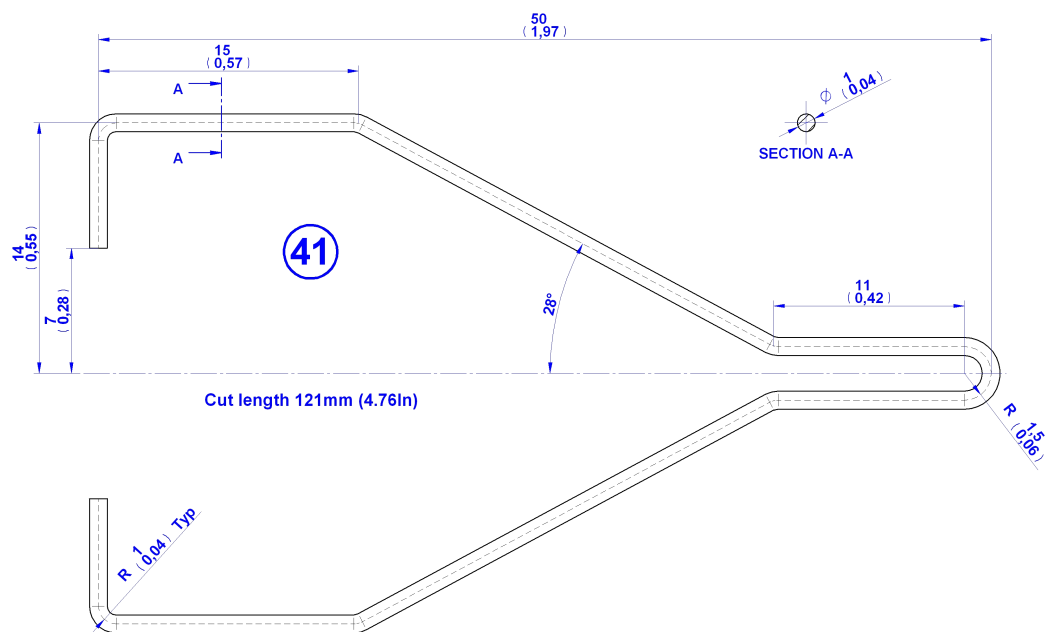
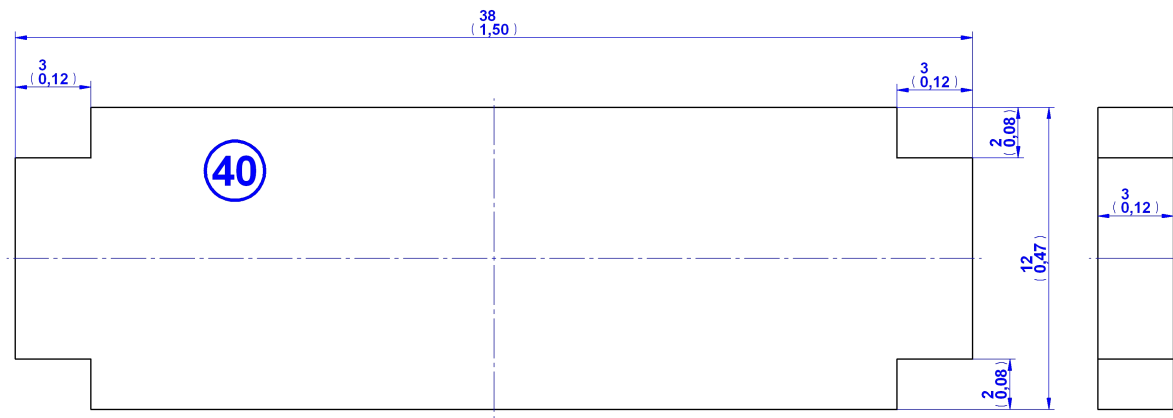

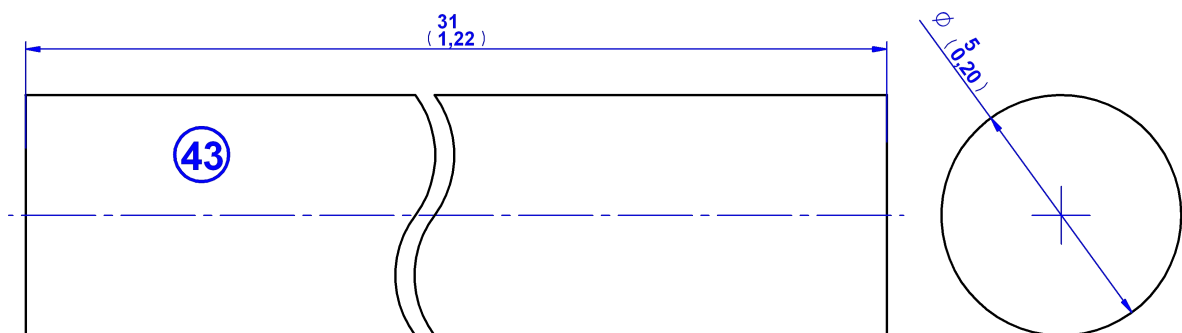
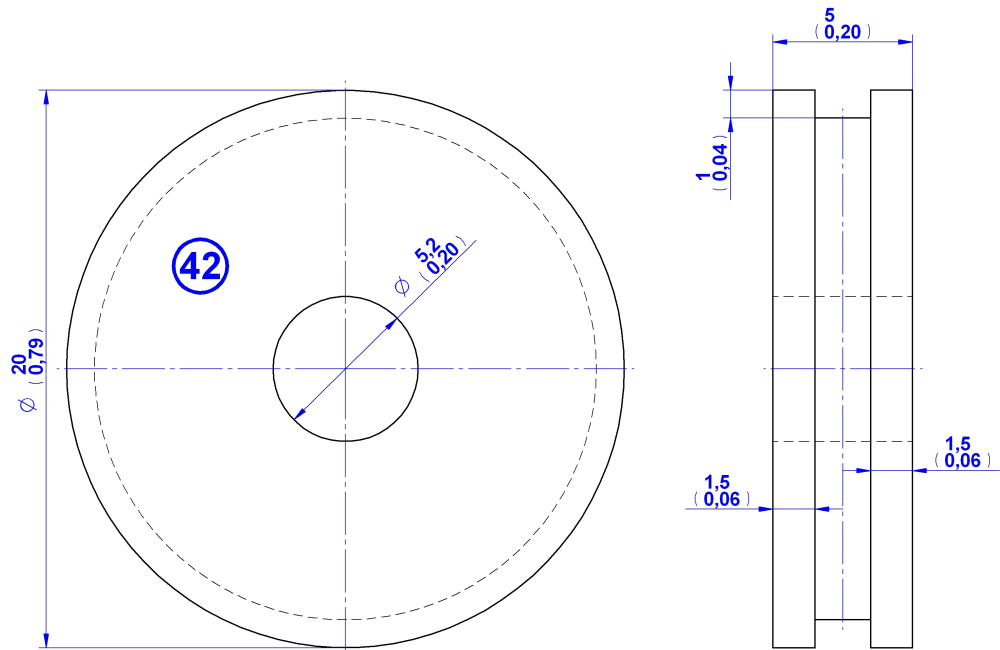

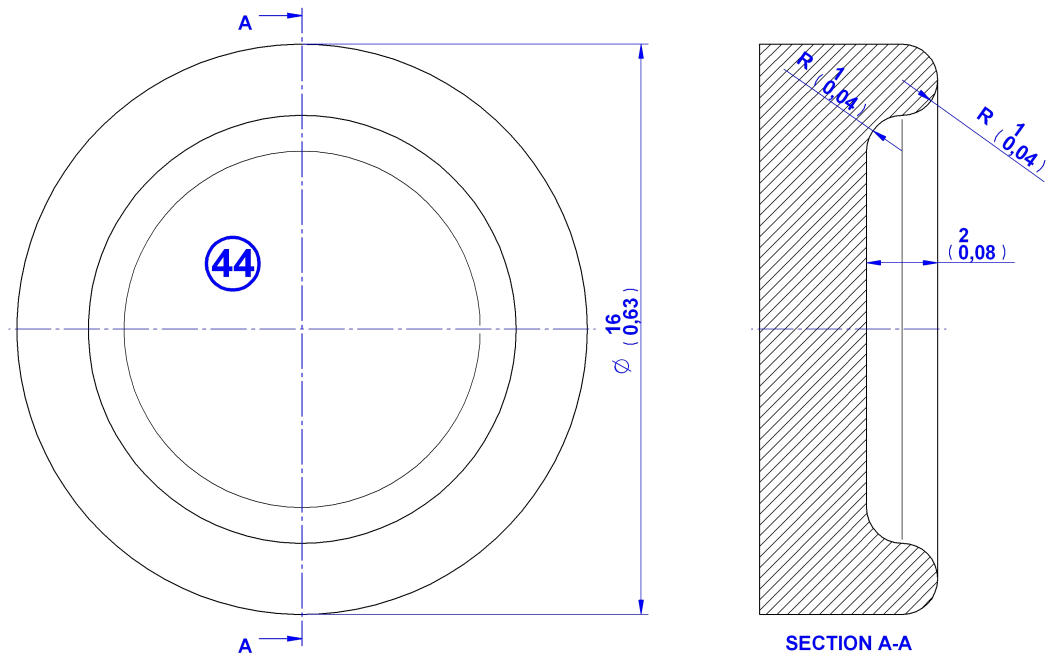

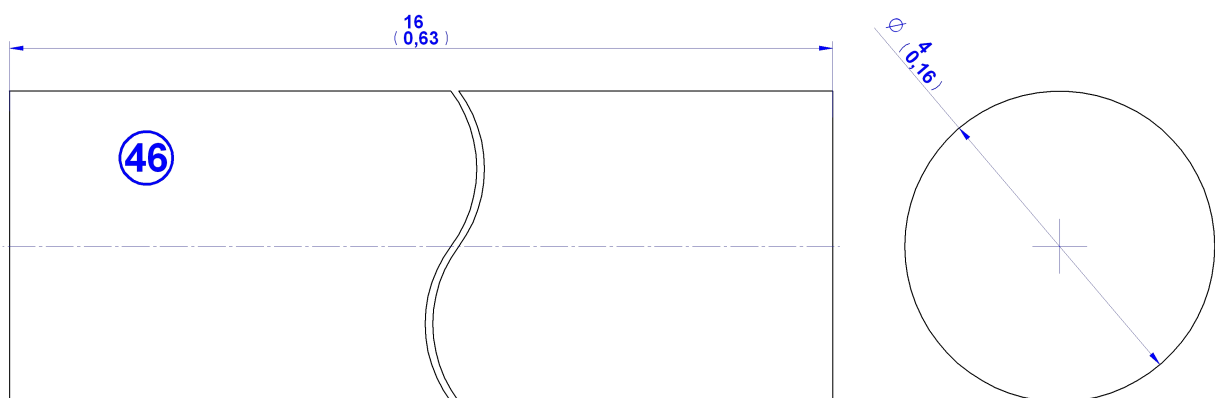
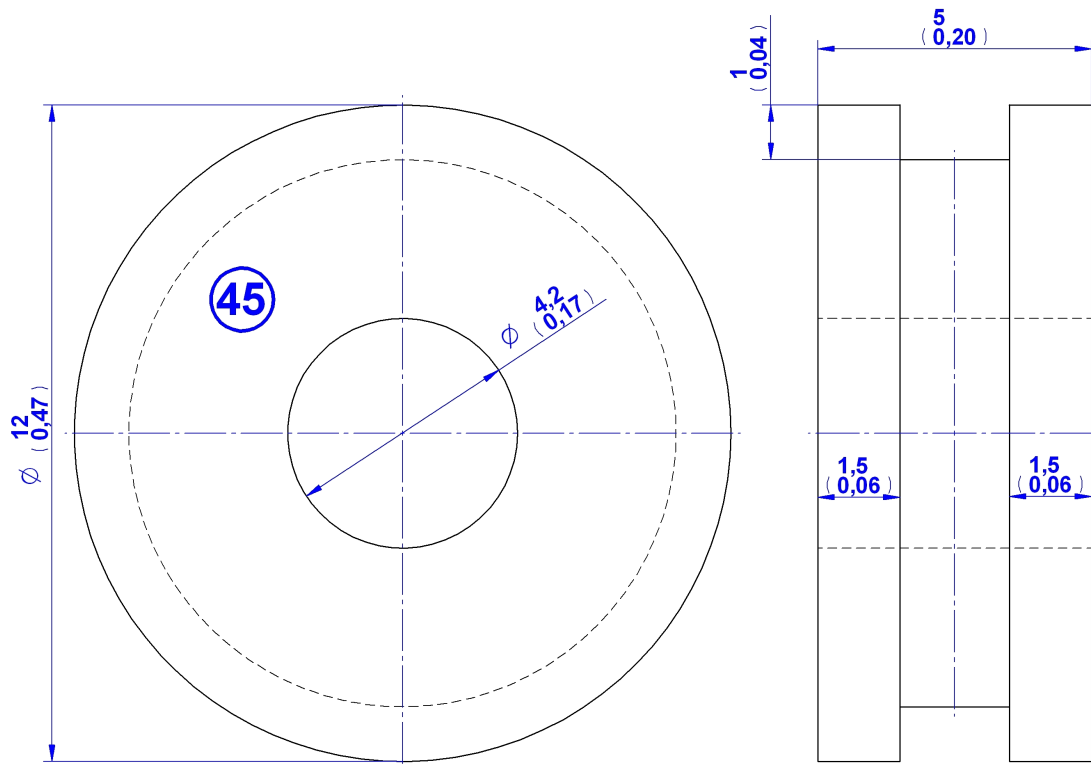

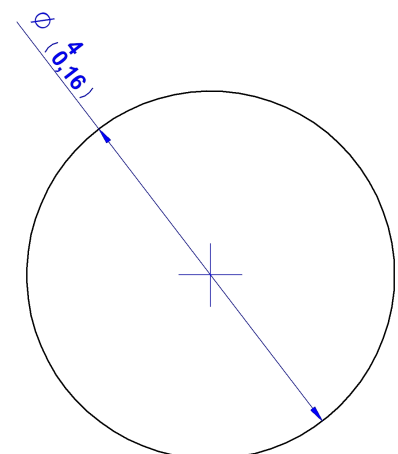
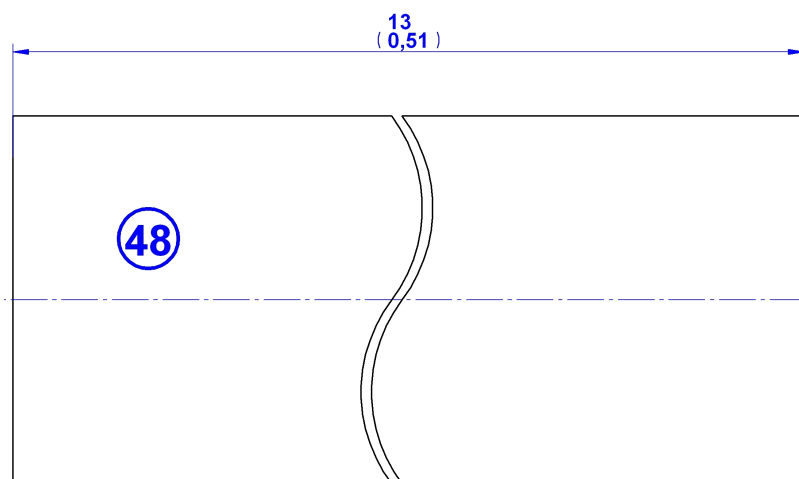
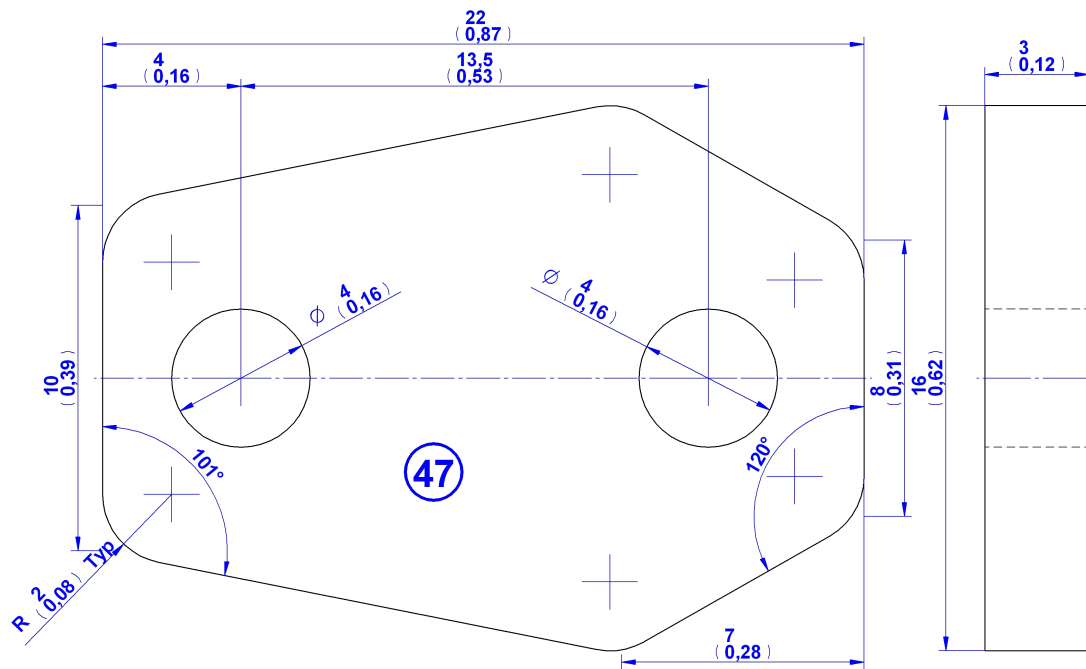

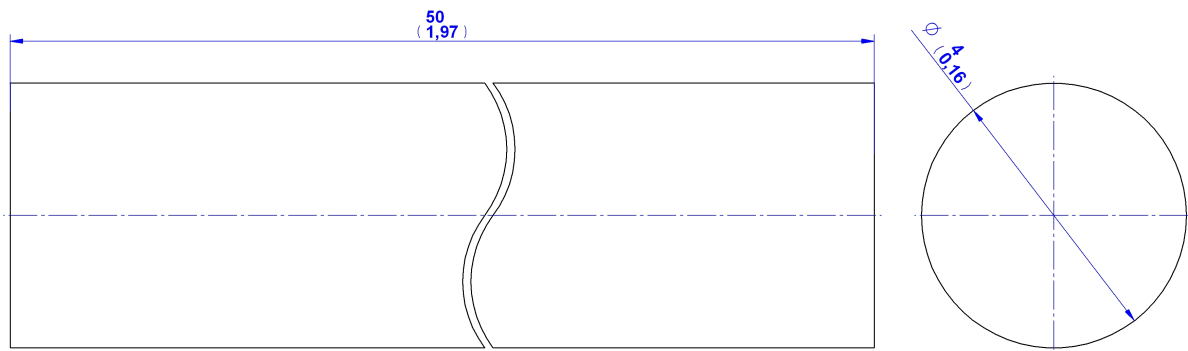
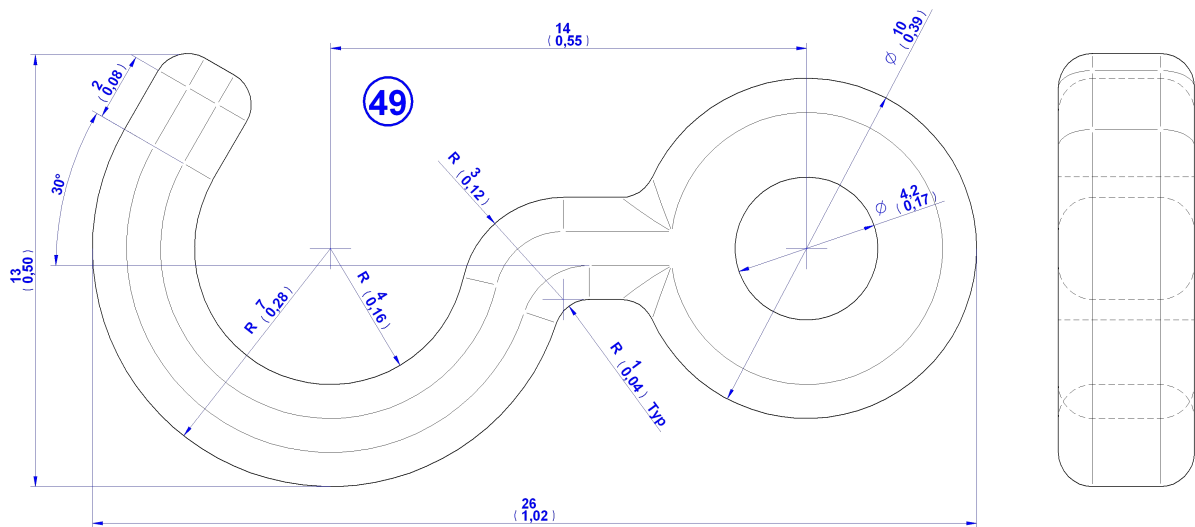
**50**

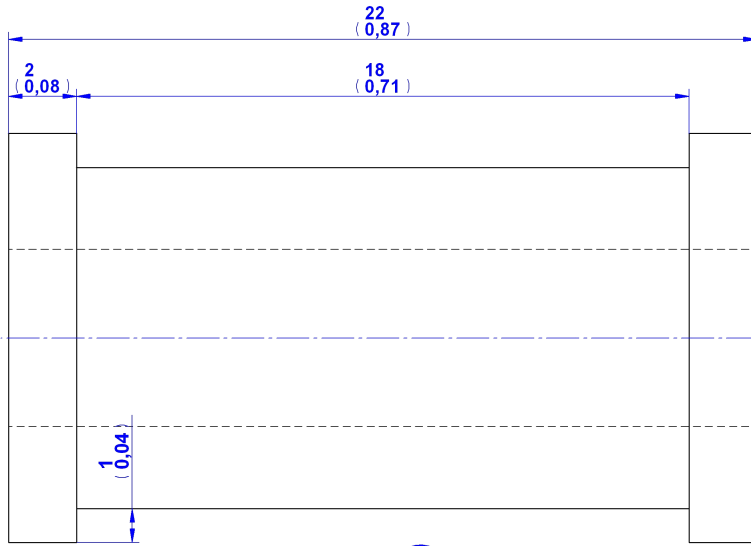
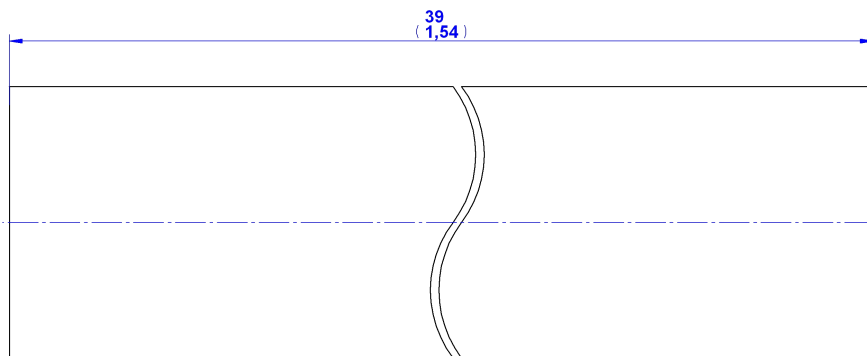
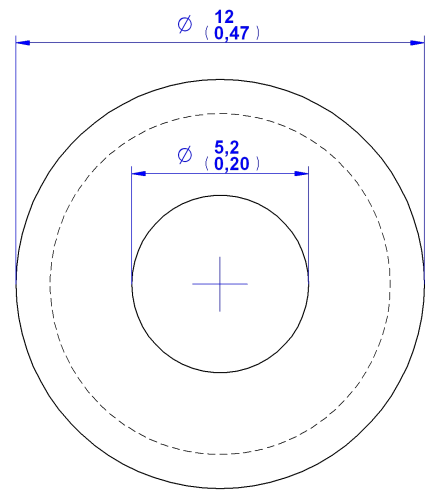
**51****52**