

WIRES ARE HOUSED IN A VINYL TUBE.
T IS THE EARTH TERMINAL

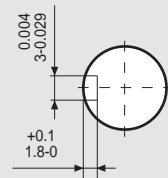
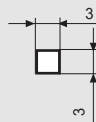
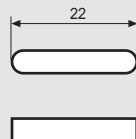

MODEL	A	B	C
103 - 845 - 6741	130.0	30.2	
103 - 845 - 6711	130.0	30.2	25.4

CHARACTERISTICS

MODEL	103 - 845 - 6741 (103 - 845 - 6711)
BASIC STEP ANGLE	1.8° ± 0.09°
BIPOLAR PARALLEL CURRENT (Amp)	9.5
UNIPOLAR CURRENT (Amp)	6.7
RESISTANCE (Ohm)	0.45
INDUCTANCE (mH)	2.0
BIPOLAR HOLDING TORQUE (Ncm)	510
UNIPOLAR HOLDING TORQUE (Ncm)	410
ROTOR INERTIA (Kgm ² x 10 ⁻⁷)	1550
THEORETICAL ACCELERATION (rad x sec. ⁻²)	32900
BACK E.M.F. (V/Krpm)	46
MASS (Kg)	3.6
PROTECTION DEGREE	IP43
LEADS CODE	II

Codes between brackets refer to double shaft model.

