

Tampo 970mm x 1440mm em perfil 40 x 80

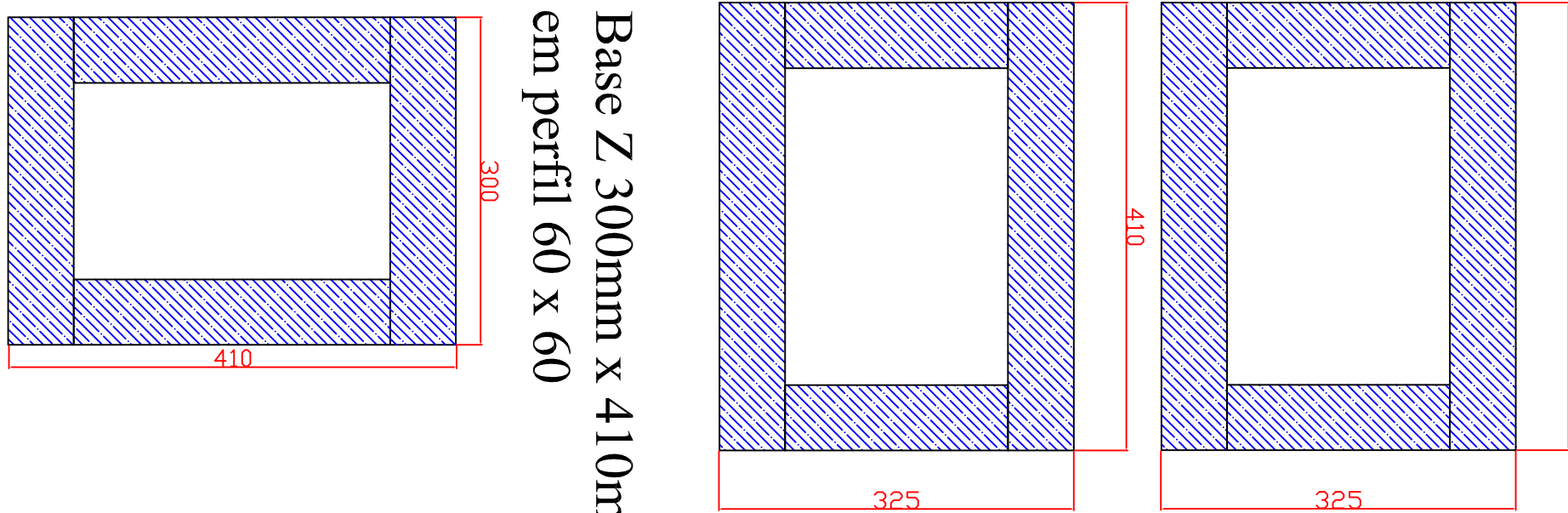

Laterais 410mm x 325mm em perfil 60 x 60

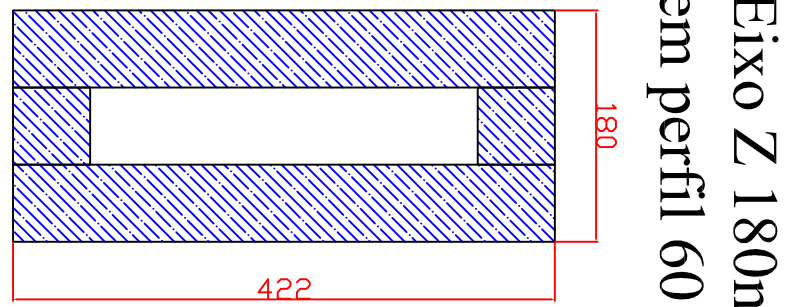

Eixo Z 180mm x 410mm em perfil 60 x 60

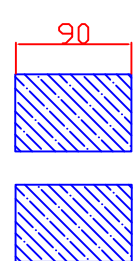

Base do fuso x 90mm em perfil 60 x 60

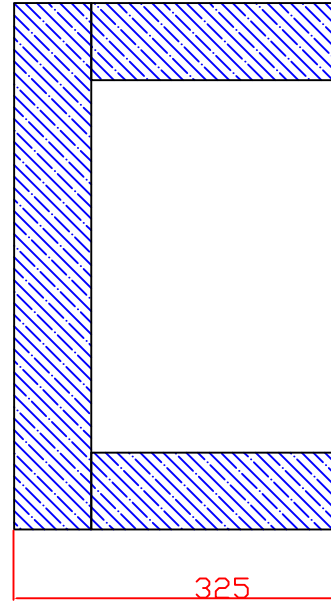

Base Z 300mm x 410mm em perfil 60 x 60

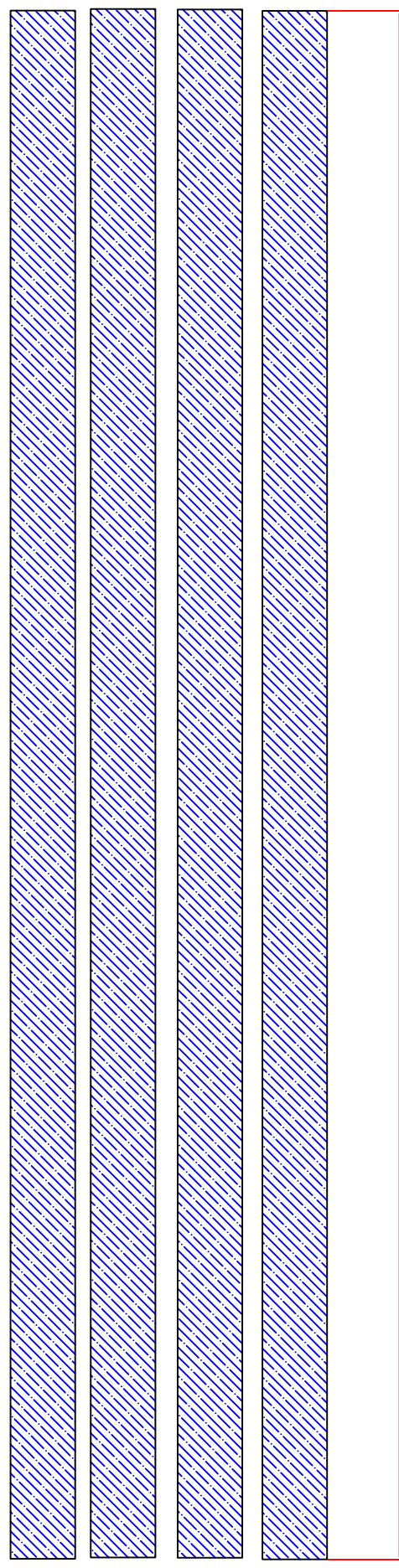

Base Y 1440mm em perfil 60 x 60

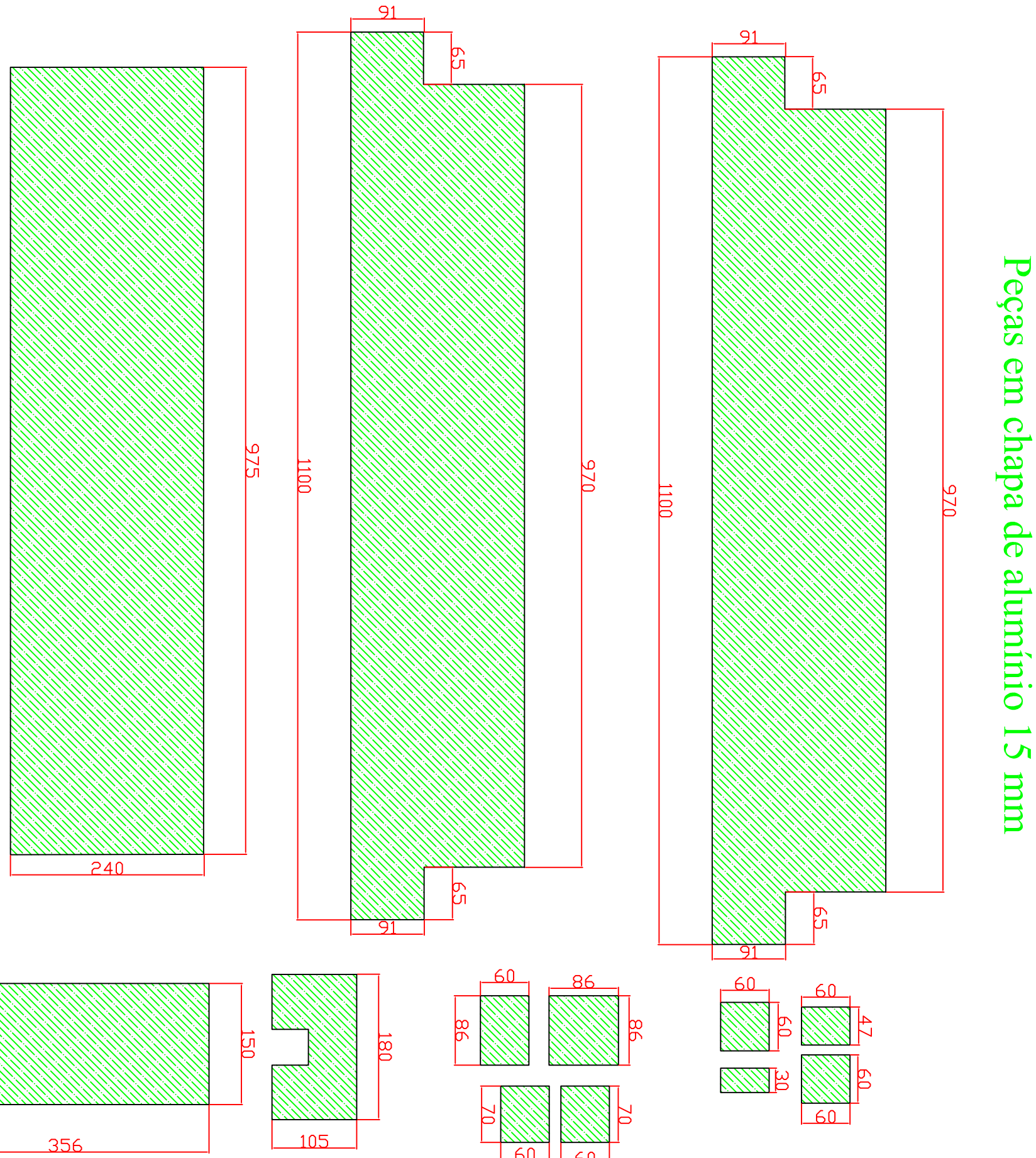
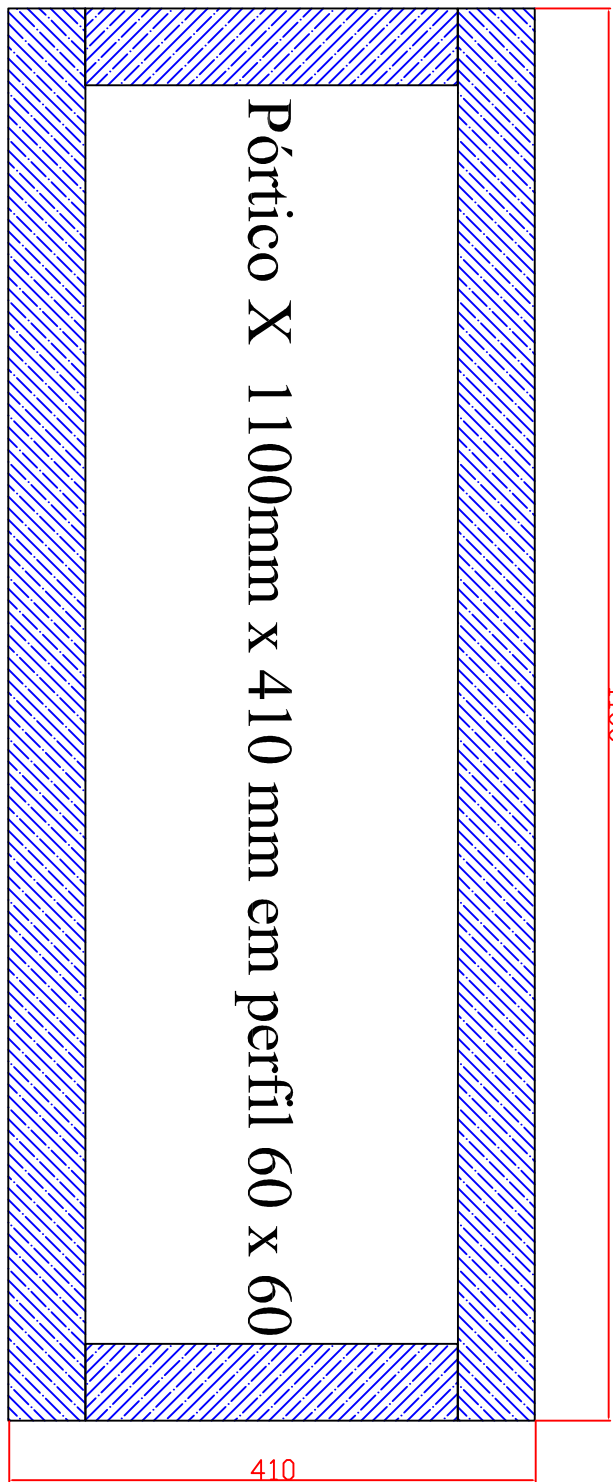

Pecas em chapa de alumínio 15 mm

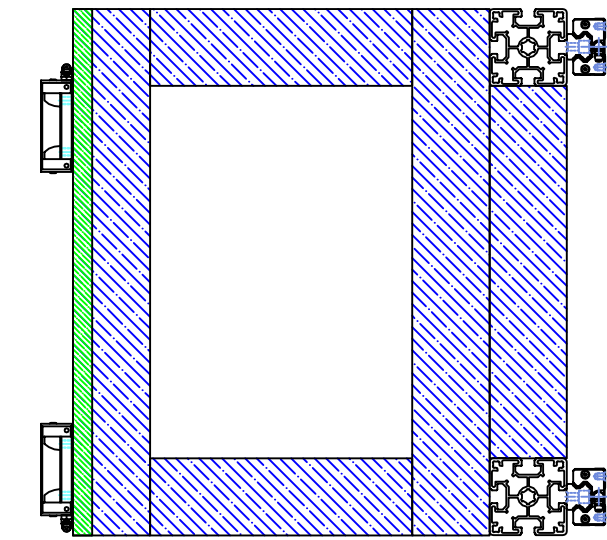
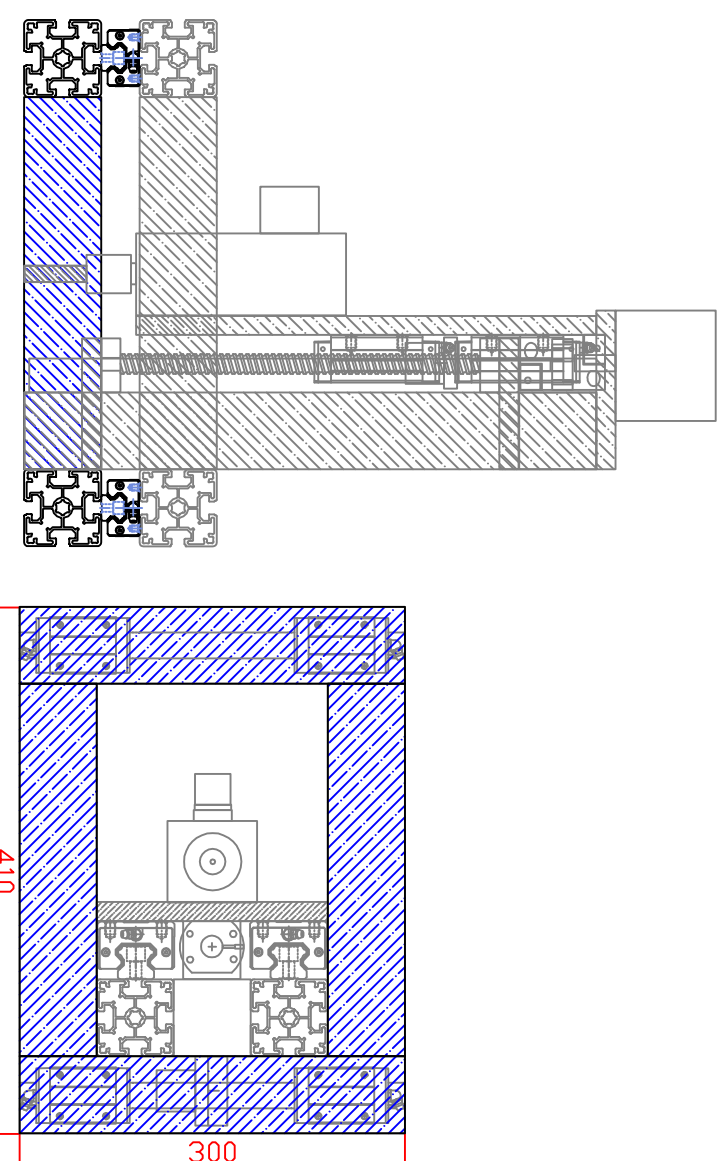

Acoplamento

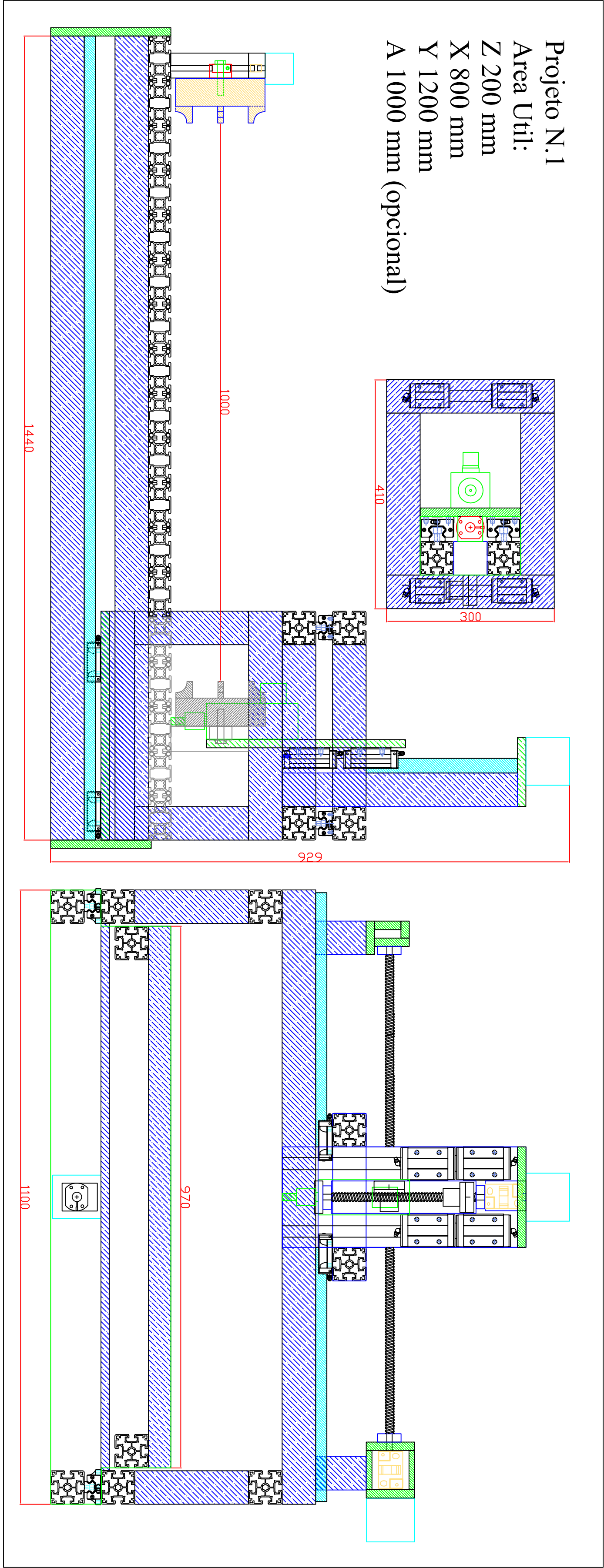
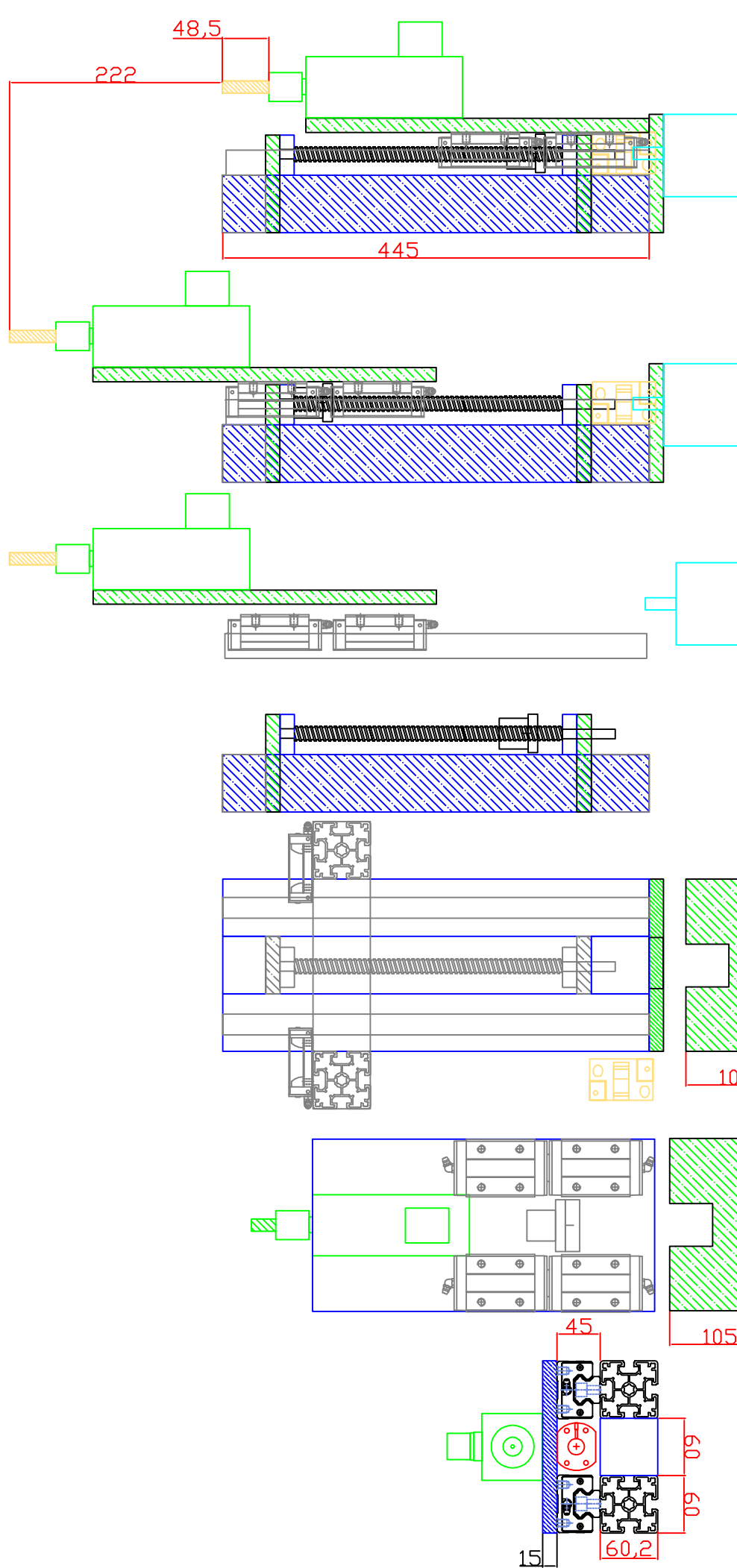

Projeto N.1  
Area Util:  
Z 200 mm  
X 800 mm  
Y 1200 mm  
A 1000 mm (opcional)

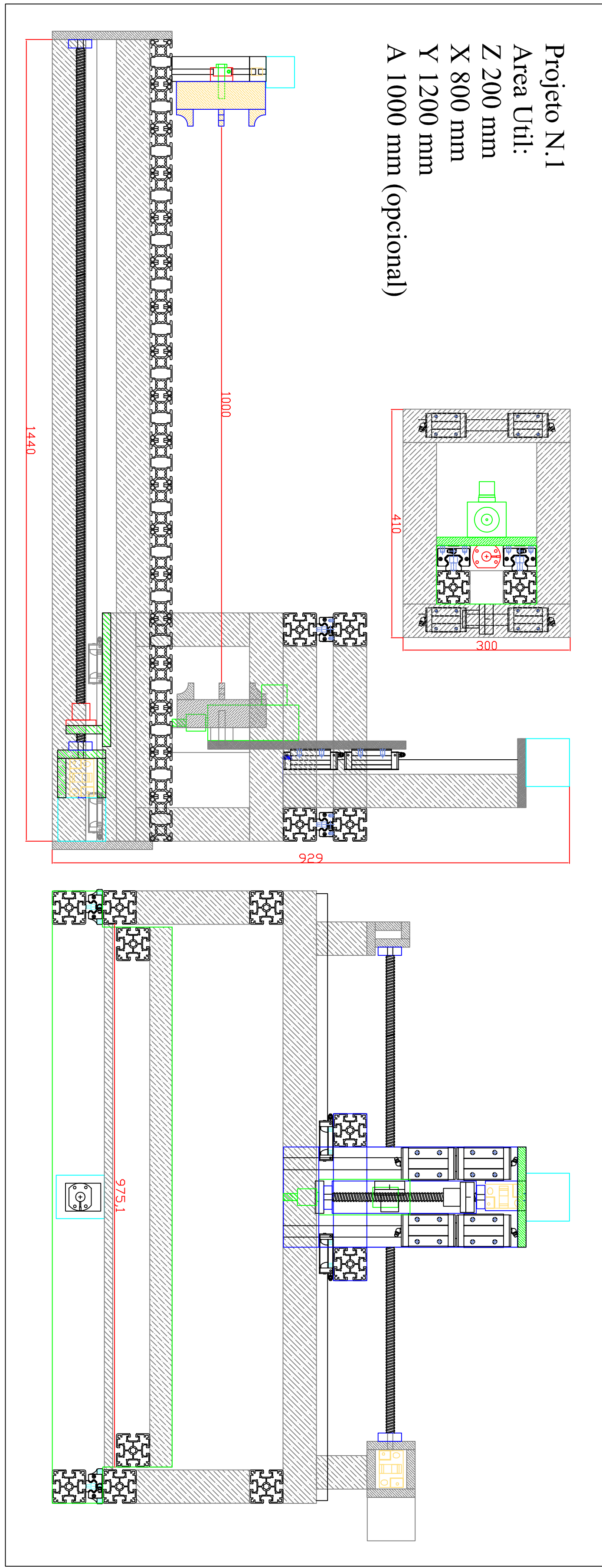

Projeto N.1  
Area Util:  
Z 200 mm  
X 800 mm  
Y 1200 mm  
A 1000 mm (opcional)

- Legendas, Observação trabalho em progresso!!  
Disponível apenas para estudo de cinemática!
- Perfil 40 x 80
- Perfil 60 x 60
- Alumínio 15 mm
- Guia linear
- Eixo rotatório
- Motor de passo