

MOTOR DE PASSO KTC-HT23 / NEMA 23

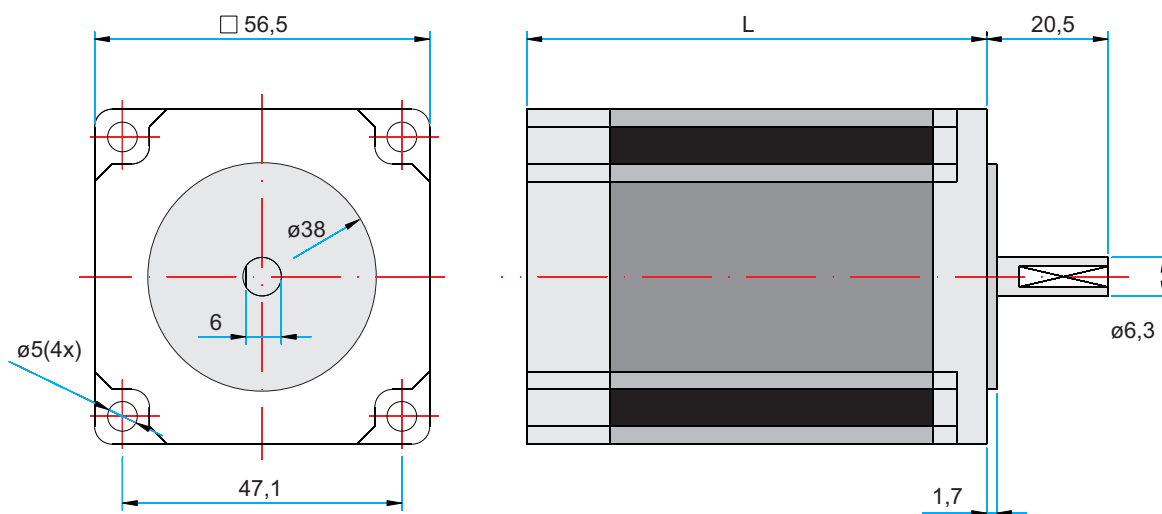

MODELO	LIGAÇÃO DO MOTOR 1=SÉRIE 2=PARALELO 3=UNIOLAR	COMPRIMENTO "L" (mm)	MINIMO TORQUE ESTÁTICO (N.m)	FIOS	STEP (ÂNGULO)	VOLTS	AMPS	OHMS	mH	ROTOR INÉRCIA (g.cm2)	MOTOR PESO (Kg)
KTC-HT23-394	1	40,6	0,54	8	1,8	4,0	1,41	2,8	5,6	120	0,45
	2					2,0	2,38	0,7	1,4		
	3		0,538			2,8	2,00	1,4	1,4		
KTC-HT23-397	1	59	1,25	8	1,8	5,1	1,41	3,6	10,0	300	0,69
	2					2,5	2,38	0,9	2,5		
	3		0,88			3,6	2,00	1,8	2,5		
KTC-HT23-400	1	76	1,86	8	1,8	6,4	1,41	4,5	14,4	480	1,00
	2					3,2	2,38	1,1	3,6		
	3		1,32			4,5	2,00	2,3	3,6		
KTC-HT23-401	1	76	1,86	8	1,8	4,2	2,12	2,0	6,4	480	1,00
	2					2,1	4,24	0,5	1,6		
	3		1,32			3,0	3,00	1,0	1,6		

KALATEC KTC-HT23-394 MOTOR

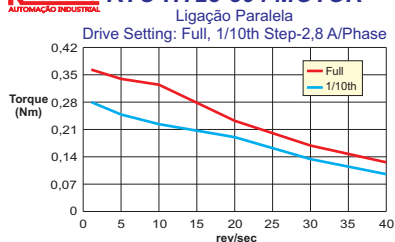

KALATEC KTC-HT23-397 MOTOR

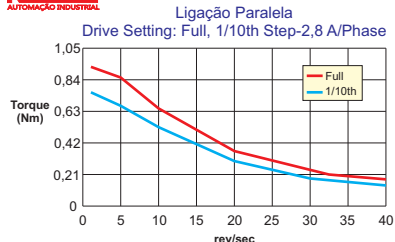

KALATEC KTC-HT23-400 MOTOR

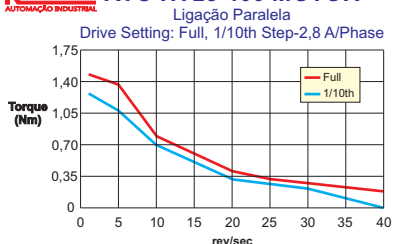

KALATEC KTC-HT23-401 MOTOR

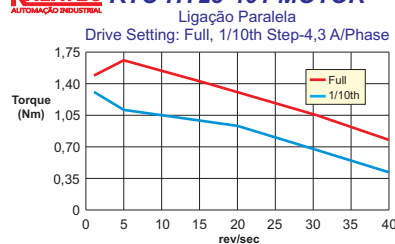

KALATEC

MOTORES

LIGAÇÃO PARALELA

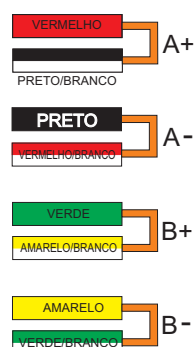

+VELOCIDADE
-TORQUE

LIGAÇÃO SÉRIE

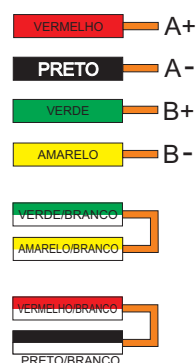

- VELOCIDADE
+TORQUE